

# Quartz perpetual calendar

---

## User Manual

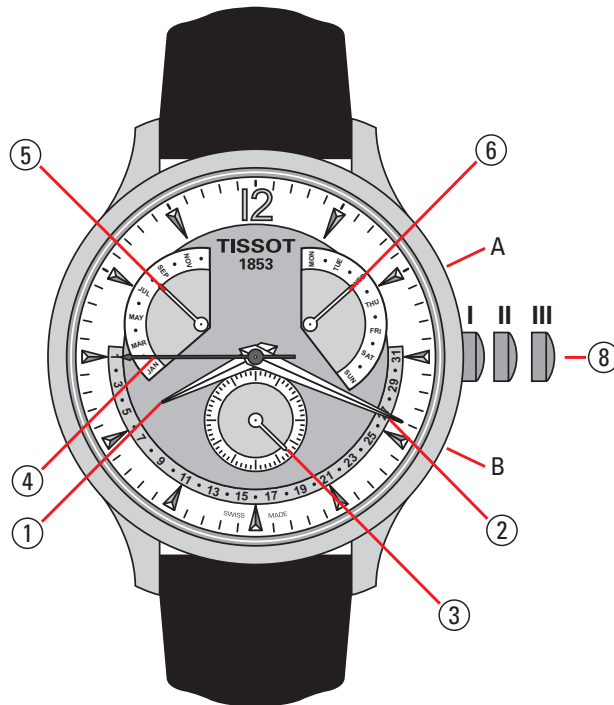

- ① Hour hand
- ② Minute hand
- ③ Seconds hand
- ④ Date hand
- ⑤ Month hand
- ⑥ Week day hand

**⑧ Crown with 3 positions**

- I Neutral position (screwed down\*, not pulled out)
- II Reset position (unscrewed\*, half pulled out)
- III Setting position for time (unscrewed\*, completely pulled out)

**\* Models with screw-down crown:**

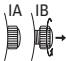

**IA** Initial position (screwed down, not pulled out)

**IB** Neutral position (unscrewed, not pulled out)

## Acknowledgements

Thank you for choosing a perpetual calendar watch from TISSOT®, a Swiss brand among the most highly renowned in the world. Meticulously assembled using high quality materials and components, it is protected against impacts, temperature variations, water and dust.

This manual applies to TISSOT® GMT quartz perpetual calendars with a G15 movement.

To ensure that your perpetual calendar operates with perfect precision for many years to come, we advise you to pay careful attention to the advice given in this manual.

## Settings

### Models with screw-down crown

To ensure even better water resistance, some models are fitted with a screw-down crown. Before setting the time or date, you must first unscrew the crown to position **IB**, before pulling it out to position **II** or **III**.

**Important: After each operation, you must always screw the crown back down to ensure that your watch remains water-resistant.**

### Setting the time

Pull the crown out to position **III** and turn it clockwise or anticlockwise to set the desired time. Synchronise the small second hand at the 6 o'clock position with an official time signal (radio/ TV/Internet), by pulling the crown out to the second position; the hand will stop. Once the time is synchronised, push the crown back into position **I** (and tighten it back down on models with screw-down crown).

### Winding

Quartz watches do not need to be wound.

## Resetting the indicators

The day, month and date hands may need to be reset.

The indicators are reset with the crown in position **II**. Corrector **A** allows the selected indicator to be set. Corrector **B** allows selection of the indicator to be reset.

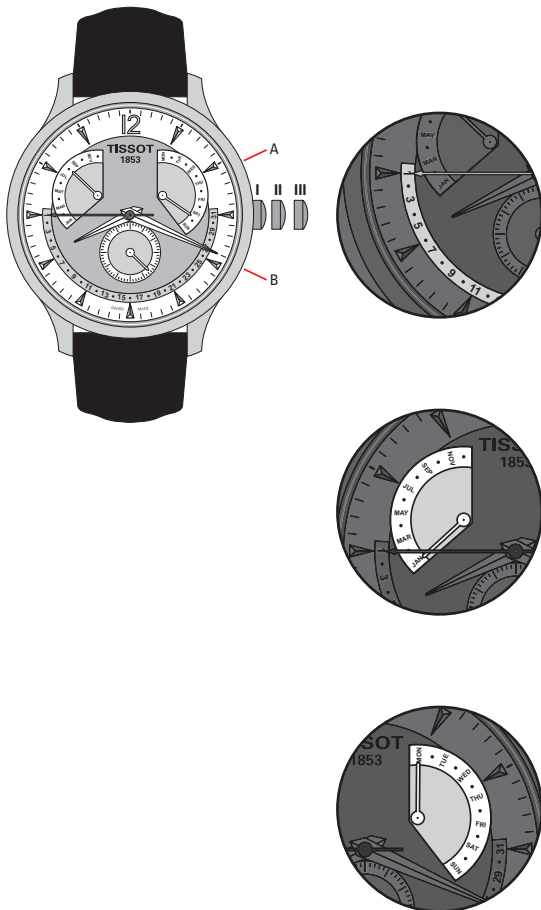

### Resetting the date indicator hand

- With the crown in position **II**, corrector **A** for the date at 1.

### Resetting the month indicator hand

- With the crown in position **II**, press corrector **B** and then corrector **A** for the month to January (JAN).

### Resetting the day indicator hand

- With the crown in position **II**, press corrector **B** and then corrector **A** to Monday (MON).

## Setting the date

Leap years are years which have 366 days. They are divisible by 4, by 400, but not by 100. Non-leap years have 365 days. 2008, 2012, 2016, . . . , 2400 are leap years whereas 2009, 2010, 2011, 2013, . . . , 2100 are not.

Year 1	Year 2	Year 3	Year 4 leap year
2009	2010	2011	2012
2013	2014	2015	2016
2017	2018	2019	2020
2021	2022	2023	2024
2025	2026	2027	2028
2029	2030	2031	2032

The date is set with the crown in position **III**. Corrector **B** allows selection of the indicator to be set. Corrector **A** allows the selected indicator to be set.

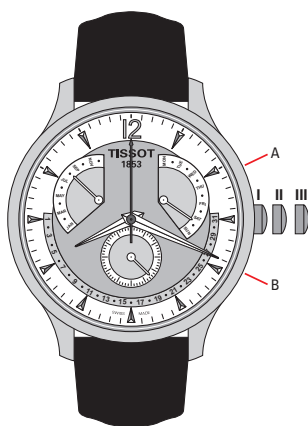

## Setting the year

- With the crown in position **III**, corrector **A** (year 4 is the leap year)

## Setting the month indicator

- With the crown in position **III**, press corrector **B** and then corrector **A**

## Setting the date

- With the crown in position **III**, press corrector **B** and then corrector **A**

## Setting the day

- With the crown in position **III**, press corrector **B** and then corrector **A**

## Care and maintenance

We would advise you to clean your perpetual calendar regularly (except for the leather strap) using a soft cloth and lukewarm soapy water. After immersion in salt water, rinse it in fresh water and leave it to dry completely.

Do not leave it anywhere subjected to high variations in temperature or humidity, direct sunlight or strong magnetic fields.

We would advise you to have your watch inspected every 3 to 4 years by an approved TISSOT® representative or retailer. To enjoy impeccable maintenance service and ensure the guarantee remains valid, always consult an approved TISSOT® representative or retailer.

**TISSOT® perpetual calendars** have the incomparable precision of quartz. Their power reserve is usually more than 2 years in continuous use.

### Replacing the battery

Once the battery has been drained, it must be replaced without delay by an approved TISSOT® representative or retailer.

Battery type: silver oxide and zinc button cell, 1.55 V, No. 394, SR 936 SW.

### Collection and treatment of end of life quartz watches\*



*This symbol indicates that this product should not be disposed of as household waste. It must be returned to an approved collection point. By following this procedure you will contribute to safeguarding the environment and human health. Recycling the materials will help to conserve natural resources.*

*\* valid in the EU member states and in any countries with corresponding legislation.*