



SCUDERIA FERRARI OROLOGI

OPERATING INSTRUCTIONS, CARE & MAINTENANCE,
AND WARRANTY & SERVICE INFORMATION

SCUDERIA FERRARI WATCHES

Asserting Scuderia Ferrari's proud racing heritage and Italian pedigree, the Scuderia Ferrari Orologi collection for men, women and children brings the passionate excitement and distinctive style of the time-honored racing team to fans around the world. Congratulations on your purchase.

Table of Contents

OPERATING INSTRUCTIONS – TIMEPIECES

(1) 2-HAND AND 3-HAND MODELS WITHOUT DATE	5
quartz and automatic <i>Includes select Academy, Apex, Donna Formula Sportiva, Donna Race Day, Donna Ultraleggero, Formula Italia S, Forza, GTB-C, Gran Premio skeleton, Lap Time, Pilota, Pista, Pit Crew, Pit Lane, Red Rev, Red Rev T, SF Basics, Speciale, Speciale Evo automatic, Speedracer, Ultraleggero, XX Kers and Young Collection 2- and 3-hand watch models</i>	
(2) 3-HAND QUARTZ MODELS WITH DATE DISPLAY	6
<i>Includes select Abetone, Aerodinamico, Apex, Aspire, Formula Italia, Formula Sportiva, FXX, Grand Tour, Pit Crew, Lap Time, Pilota, Pilota Donna, Red Rev T and Red Rev Evo 3-hand with date watch models</i>	
(3) 3-HAND QUARTZ MODELS WITH DAY/DATE DISPLAY	7
<i>Includes select D50, Gran Premio Quartz and Scuderia watch models</i>	
(4) 3-HAND AUTOMATIC MODELS WITH DAY/DATE DISPLAY	8
<i>Includes Swiss Made Limited Edition Primato</i>	
(5) QUARTZ MULTI-FUNCTION MODELS – TYPE A	9
with small date and 24-hour hands <i>Includes FXX multi-function watch models, Ultraleggero</i>	
(6) QUARTZ MULTI-FUNCTION MODELS – TYPE B	10
with small day/date/24-hour hands <i>Includes select Abetone, Apex, Grand Tour and Speedracer multi-function watch models</i>	
(7) QUARTZ MULTI-FUNCTION MODELS – TYPE C	11
with small day, date and 24-hour (select models) hands <i>Includes select Aero, Aspire, Donna Scudetto, Forza, FXX, Kers Extreme, Lap Time, Pista, Pit Crew, Pilota, Red Rev T, Rev-Up, Speciale, Speedracer, Speedracer and Turbo multi-function watch models</i>	
(8) QUARTZ GMT MODELS WITH DATE DISPLAY	12
<i>Includes Select Pilota GMT Models</i>	
(9) AUTOMATIC MULTI-FUNCTION MODELS	13
with small seconds/24-hour hands and skeleton dial aperture <i>Includes select Gran Premio and Primato Automatic watch models</i>	
(10) AUTOMATIC CHRONOGRAPHS MODELS	14
<i>Includes Pilota and Aspire Automatic Swiss Made Limited Edition watch models</i>	
(11) QUARTZ ANALOG CHRONOGRAPHS 1/1 OF A SECOND – TYPE A	15
with small chronograph minutes/seconds counters and 24-hour hand <i>Includes select Heritage and Race Day quartz chronograph models</i>	



Table of Contents (cont'd)

(12) QUARTZ ANALOG CHRONOGRAPHS 1/1 OF A SECOND – TYPE B	17
with small chronograph minutes/seconds counters and 24-hour hand <i>Includes Paddock quartz chronograph models</i>	
(13) QUARTZ ANALOG CHRONOGRAPHS 1/1 OF A SECOND – TYPE C	18
with small chronograph minutes/seconds counters and 24-hour hand, and date <i>Includes select Aerodinamico, Gran Premio Quartz, GTB-C and Lap Time quartz chronograph models</i>	
(14) QUARTZ ANALOG CHRONOGRAPHS 1/1 OF A SECOND – TYPE D	19
with small chronograph minutes counter and 24-hour hand, and date <i>Includes select D50 and Formula Italia quartz chronograph models</i>	
(15) QUARTZ ANALOG CHRONOGRAPHS 1/1 OF A SECOND – TYPE E	20
with small chronograph minutes/seconds counters, small 24-hour hand (select models), and date <i>Includes select Aspire, Formula Italia S, Pilota, Pista, Primato, Race Day, Red Rev Evo and Speciale Evo quartz chronograph models</i>	
(16) QUARTZ ANALOG CHRONOGRAPHS 1/4 OF A SECOND	22
with center-mounted chronograph quarter-of-a-second hand, small chronograph minutes counter and seconds hand, and date <i>Includes Formula Sportiva quartz chronograph models</i>	
(17) QUARTZ ANALOG CHRONOGRAPHS 1/5 OF A SECOND – TYPE A	23
with center-mounted chronograph fifths-of-a-second hand, small chronograph minutes counter, and small seconds and 24-hour hands <i>Includes select Heritage, Race Day and Scuderia quartz chronograph models</i>	
(18) QUARTZ ANALOG CHRONOGRAPHS 1/5 OF A SECOND – TYPE B	24
with center-mounted chronograph fifths-of-a-second hand, small chronograph hours/minutes counters, small seconds hand, and date <i>Includes select Cronometro, Lap Time, Race Day and Ready-Set-Go quartz chronograph models</i>	
(19) QUARTZ ANALOG CHRONOGRAPHS 1/5 OF A SECOND – TYPE C	25
with center-mounted chronograph fifths-of-a-second hand, small chronograph 30-minutes counters, and small seconds and date indicator hands <i>Includes Scuderia XX Swiss quartz chronograph models</i>	
(20) QUARTZ ANALOG CHRONOGRAPHS 1/10 OF A SECOND	26
with small chronograph minutes/seconds counter and chronograph tenths of a second counter <i>Includes Speedracer quartz chronograph models</i>	
(21) QUARTZ ANALOG-DIGITAL CHRONOGRAPH MODELS – TYPE A	27
with alarm function <i>Includes Lap Time quartz Ana-Digi models</i>	
(22) QUARTZ ANALOG-DIGITAL CHRONOGRAPH MODELS – TYPE B	29
with alarm function <i>Includes Aerodinamico and Aero Evo quartz Ana-Digi models</i>	
(23) AUTOMATIC WORLDTIME MODELS	31
with city time zone indication <i>Includes select Gran Premio limited edition Swiss automatic models</i>	
(24) AUTOMATIC BI-RETROGRADE SKELETON MODELS	32
<i>Includes F14-R limited edition Swiss automatic models</i>	



Table of Contents (cont'd)

(25) DIGITAL TOUCH-SCREEN MODELS	33
with LED dual-time zone and month/date display <i>Includes Aero Touch digital quartz models</i>	
(26) ANALOG/DIGITAL TRIPLE-MOVEMENT MODELS	34
with analog 2-hand, analog 3-hand, and digital LED time/date movements <i>Includes XX Kers special edition models</i>	
(27) DIGITAL MULTI-FUNCTION MODELS – TYPE A	35
with 12-digit LED display <i>Includes Digitale multi-function models</i>	
(28) DIGITAL MULTI-FUNCTION MODELS – TYPE B	37
with 13-digit LED display <i>Includes Forza Digital models</i>	
(29) DIGITAL MULTI-FUNCTION MODELS – TYPE C	38
with 10-digit LED display <i>Includes Digidrive models</i>	
(30) DIGITAL MULTI-FUNCTION MODELS – TYPE D	39
with 15-digit display <i>Includes Downforce digital models</i>	
(31) DIGITAL MULTI-FUNCTION MODELS – TYPE E	41
with 12-digit display <i>Includes Digitrack digital models</i>	
(32) CHILDREN’S SPECIALTY DIGITAL MODELS	42
with 4-digit LED display, light and sound features <i>Includes select Young Collection models</i>	
OPERATING INSTRUCTIONS – SPECIAL FEATURES	
(A) ROTATING REFLECTOR RING	43
(B) MESH BRACELET SLIDING CLASP	44
<i>Includes select Donna, Gran Premio and Ultraleggero models</i>	
(C) INTERCHANGEABLE BRACELET/STRAP MODELS	45
Tension-pin style	
CARE AND MAINTENANCE	46
WARRANTY	47
OBTAINING SERVICE	48
SERVICE REQUEST FORM	49



(1) 2-HAND AND 3-HAND MODELS WITHOUT DATE

quartz and automatic

Includes select Academy, Apex, Donna Formula Sportiva, Donna Race Day, Donna Ultraleggero, Formula Italia S, Forza, GTB-C, Gran Premio skeleton, Lap Time, Pilota, Pista, Pit Crew, Pit Lane, Red Rev, Red Rev T, SF Basics, Speciale, Speciale Evo automatic, Speedracer, Ultraleggero, XX Kers and Young Collection 2- and 3-hand watch models



Figure A



Figure D



Figure B



Figure C

LEGEND

H - Hour hand
M - Minute hand
S - Seconds or small seconds hand

1, 2 - Crown positions

Crown Positions:

Position 1 - Normal position.
Crown pushed against case.
Position 2 - To set TIME:
Rotate crown in either direction.

To WIND an automatic movement by hand:

The motion of your arm during normal daily activities should be sufficient to keep the movement of your automatic timepiece wound. However, if you have not worn your watch for approximately 38 to 40 hours or more, and the watch has stopped, you will need to wind it by hand before setting the time:

1. With the crown in position 1, turn the crown clockwise approximately 20 revolutions.
2. Reset time following instructions above.



(2) 3-HAND QUARTZ MODELS WITH DATE DISPLAY

Includes select Abetone, Aerodinamico, Apex, Aspire, Formula Italia, Formula Sportiva, FXX, Grand Tour, Pit Crew, Lap Time, Pilota, Pilota Donna, Red Rev T and Red Rev Evo 3-hand with date watch models



Figure A

LEGEND

H - Hour hand
M - Minute hand
S - Seconds hand
D - Date display

1, 2, 3 - Crown positions

Crown Positions:

Position 1 - Normal position. Crown pushed against case.
Position 2 - To set DATE*: Rotate crown either counterclockwise or clockwise, depending on model.
Position 3 - To set TIME: Rotate crown in either direction.

*CAUTION: Never set the Date when the hands are between 9:00 PM and 4:00 AM. Doing so could damage the calendar mechanism.

NOTE: The functioning of the watch is not affected during date setting. When the watch is running, the Date will change gradually during the period from 9:00 PM to 4:00 AM.



(3) 3-HAND QUARTZ MODELS WITH DAY/DATE DISPLAY

Includes select D50, Gran Premio Quartz and Scuderia watch models



Figure A

LEGEND

- H – Hour hand
- M – Minute hand
- S – Seconds hand
- W – Day display
- D – Date display

1, 2, 3 – Crown positions

Crown Positions:

- Position 1 - Normal position. Crown pushed against case.
- Position 2 - To set DAY: Rotate crown clockwise.
To set DATE: Rotate crown counterclockwise.
- Position 3 - To set TIME: Rotate crown in either direction.

NOTE: When the watch is running, the Date will change gradually between 11:00 PM and 12:00 AM, and the Day will change gradually between 2:00 AM and 4:00 AM.

IMPORTANT: Do not adjust the Day or Date between the hours of 9:00 PM and 4:00 AM when automatic calendar changes are in progress, or the Day and Date may not change properly on the following day.



(4) 3-HAND AUTOMATIC MODELS WITH DAY/DATE DISPLAY

Includes Swiss Made Limited Edition Primato



Figure A

LEGEND

- H - Hour hand
- M - Minute hand
- S - Seconds hand
- W - Day display
- D - Date display
- R - Reflector ring crown
- C - Screw down crown

1, 2, 3 - Crown positions

Crown Positions:

Position 1 - Normal running position. Crown pushed against case.

Position 2 - To set DATE: Rotate crown clockwise.

To set DAY: Rotate crown counterclockwise.

Position 3 - To set TIME: Rotate crown in either direction.

NOTE: When the watch is running, the Date will change gradually between 11:00 PM and 12:00 AM, and the Day will change gradually between 2:00 AM and 4:00 AM.

NOTE: If your watch has a screw down crown, before you can set the Date (Day/Date) or Time, you must first unlock the crown by turning it counterclockwise approximately six rotations. After Time/Date (Day/Date) setting, the crown must be screwed back down into the case to ensure water resistance.

IMPORTANT: Do not adjust the Day or Date between the hours of 9:00 PM and 4:00 AM when automatic calendar changes are in progress, or the Day and Date may not change properly on the following day.

This automatic model features a 26-jewel Sellita self-winding movement with 38-hour power reserve and a balance frequency of 28,800 vibrations per hour.

To manually wind an automatic movement::

The motion of your arm during normal daily activities should be sufficient to keep the movement of your Scuderia Ferrari automatic

timepiece wound. However, if you not have worn your watch for 38 hours or more, and the watch has stopped, you will need to wind it by hand before setting the time:

1. With the crown in position 1, turn the crown clockwise approximately 20 revolutions.
2. Reset time following instructions above.



(5) QUARTZ MULTI-FUNCTION MODELS – TYPE A

with small date and 24-hour hands

Includes FXX multi-function watch models, Ultraleggero



Figure A

LEGEND

H – Hour hand
M – Minute hand
S – Seconds hand
D – Date indicator
F – 24-Hour hand

1, 2, 3 – Crown positions

These multi-eye models feature center-mounted hour, minute and seconds hands, and small date and 24-hour indicators.

To set the TIME:

1. Pull crown out to position 3 when seconds hand **S** reaches 12 o'clock; watch (seconds hand **S**) stops.
2. Turn crown in either direction to set hour **H** and minute **M** hands to desired time, taking AM/PM time into account.
3. Push crown back in to position 1; watch (seconds hand **S**) restarts.

NOTES: 24-hour hand **F** will move in sync with hour hand **H**, so when setting the time, be sure to take AM/PM time into account so that 24-hour hand is set correctly.

When setting the minutes, advance minute hand **M** 4 to 5 minutes ahead of the desired time, then turn it back to indicate the exact minute.

To set the DATE:

1. Pull crown out to position 2.
2. Turn crown counterclockwise until date indicator hand **D** points to correct date.

NOTE: Date indicator hand **D** will not move when crown is turned clockwise.

3. Push crown back in to position 1.

IMPORTANT: Do not adjust the date between the hours of 9:00 PM and 1:00 AM when automatic calendar changes are in progress or the date may not change automatically on the following day.

NOTES: While setting date indicator hand **D**, check to make sure that it is moving properly in one-day increments.

It will be necessary to adjust the date following any month with fewer than 31 days.



(6) QUARTZ MULTI-FUNCTION MODELS – TYPE B

with small day, date and 24-hour hands

Includes select Abetone, Apex, Grand Tour and Speedracer multi-function watch models



Figure A



Figure B

LEGEND

H – Hour Hand
M – Minute Hand
S – Seconds Hand
W – Day Display
D – Date Indicator
F – 24-Hour Hand

A – Day corrector button
B – Date corrector button

1, 2 – Crown positions

To set the TIME:

1. Pull crown out to position 2 when seconds hand **S** reaches 12 o'clock; watch (seconds hand **S**) stops.
2. Turn crown in either direction to set hour **H** and minute **M** hands to desired time, taking AM/PM time into account.
3. Push crown back in to position 1; watch (seconds hand **S**) restarts.

NOTES: 24-hour hand **F** will move in sync with hour hand **H**, so when setting the time, be sure to take AM/PM time into account so that 24-hour hand is set correctly.

When setting the minutes, advance minute hand **M** 4 to 5 minutes ahead of the desired time, then turn it back to indicate the exact minute.

To set the DAY and DATE:

1. Use button **A** to correct weekday. Each time you press and release button **A**, Day indicator hand **W** will advance to the next day.
2. Use button **B** to correct date. Each time you press and release button **B**, Date indicator hand **D** will advance by one number/tick.

These multi-eye models feature center-mounted hour, minute and seconds hands, and small day, date and 24-hour indicators.



(7) QUARTZ MULTI-FUNCTION MODELS – TYPE C

with small day, date and 24-hour (select models) hands

Includes select Aero, Aspire, Donna Scudetto, Forza, FXX, Kers Xtreme, Lap Time, Pista, Pit Crew, Pilota, Red Rev T, Rev-Up, Speciale, Speedracer and Turbo multi-function watch models



Figure A

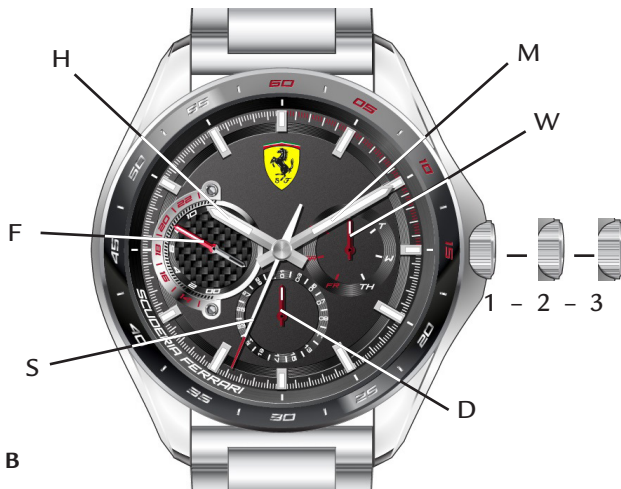

Figure B

LEGEND

H – Hour Hand
M – Minute Hand
S – Seconds Hand
D – Date Indicator
W – Day Indicator
F – 24-Hour Hand

1, 2, 3 – Crown positions

These multi-eye models feature center-mounted hour, minute and seconds hands, and small day and date indicators; some models also have a small 24-hour hand.

To set the TIME and DAY:

1. Pull crown out to position 3 when seconds hand **S** reaches 12 o'clock; watch (seconds hand **S**) stops.
2. Turn crown clockwise to advance hour **H** and minute **M** hands until day hand **W** indicates correct day of the week.
NOTES: Day hand **W** will not move backwards if you turn the crown counterclockwise.
To advance day hand **W** rapidly, turn crown counterclockwise, moving hour **H** and minute **M** hands back to 4 to 5 hours before the start of the automatic day change period (11:00 PM to 4:00 AM); then turn crown clockwise, moving hands **H** and **M** past midnight until day hand **W** advances by one day. Repeat as needed until correct day is indicated.
3. Turn the crown in either direction to set hands **H** and **M** to the desired time.
NOTES: 24-hour hand **F**, found on select models only, will move in sync with Hour hand **H**, so when setting the time, be sure to take AM/PM time into account so that 24-hour hand is set correctly.
When setting the minutes, advance Minute hand **M** 4 to 5 minutes ahead of the desired time, then turn it back to indicate the exact minute.
4. Push crown back into position 1; watch (seconds hand **S**) restarts.

To set the DATE:

1. Pull crown out to position 2.
2. Turn crown counterclockwise until date indicator hand **D** points to correct date.
IMPORTANT: Do not adjust the date between the hours of 9:00 PM and 1:00 AM when automatic calendar changes are in progress or the date may not change automatically on the following day.
3. Push crown back into position 1.
NOTES: You cannot move the date indicator hand **D** backwards by turning the crown clockwise.
It will be necessary to adjust the date following any month with fewer than 31 days.



(8) QUARTZ GMT MODELS WITH DATE DISPLAY

Includes Select Pilota GMT Models



Figure A

LEGEND

- H - Hour hand
- M - Minute hand
- S - Seconds hand
- G - GMT hand
- D - Date display

1, 2, 3 - Crown positions

These GMT models feature a GMT hand with date display.

To set the TIME:

1. Pull the crown out to position 3 (watch stopped).
2. Turn the crown until the current time is displayed.
3. Push the crown back into position 1.

To set the 24-hour display (GMT hand):

1. Pull the crown out to position 2 (watch still running).
2. Turn the crown counterclockwise until the desired time appears.
3. Push the crown back into position 1.

To set the DATE:

1. Pull the crown out to position 2 (watch still running).
2. Turn the crown clockwise until the required date appears.
3. Push the crown back into position 1.

Note: The date can also be changed during the day-changing phase between 10 pm and midnight. However, the date of the following day should to be set, because no automatic date change will take place at midnight.



(9) AUTOMATIC MULTI-FUNCTION MODELS

with small seconds and 24-hour hands, and skeleton dial aperture

Includes select Gran Premio and Primato Automatic watch models



Figure A

LEGEND

- H – Hour hand
- M – Minute hand
- S – Small Seconds hand
- F – 24-Hour hand
- A – Skeleton aperture

1, 2 – Crown positions

To WIND the movement by hand:

The motion of your arm during normal daily activities should be sufficient to keep the movement of your automatic timepiece wound. However, if you have not worn your watch for approximately 38 to 40 hours or more, and the watch has stopped, you will need to wind it by hand before setting the time:

1. With the crown in position 1, turn the crown clockwise approximately 20 revolutions.
2. Reset the Time following instructions below.

To set the TIME:

1. Pull crown out to position 2; watch (small seconds hand **S**) stops.
2. Turn crown in either direction to set hour **H** and minute **M** hands to desired time.
3. Push crown back in to position 1; watch (small seconds hand **S**) restarts.

NOTE: 24-hour hand **F** will move in sync with Hour hand **H** and Minute hand **M**, so when setting the time, make sure to take AM/PM time into account.



(10) AUTOMATIC CHRONOGRAPHS MODELS

Includes Pilota and Aspire Automatic Swiss Made Limited Edition watch models



Figure A

LEGEND

- H – Hour hand
- M – Minute hand
- S – Small seconds hand
- C – Chronograph seconds counter
- D – Chronograph 1 2-hour counter
- E – Chronograph 30-minutes counter
- J – Date display
- A – Chronograph push-button [start/stop]
- B – Chronograph push-button [reset]
- I, 2, 3 – Crown positions

These automatic chronograph models feature a fine 25-jewel ETA caliber A07.2 | I self-winding mechanical chronograph movement with 48-hour power reserve, minute counter (up to 30), hour counter (up to 12), and small seconds subdials; center-mounted chronograph seconds hand, and date display. They can be used to time an event up to 12 hours, 30 minutes and 59 seconds in duration to the nearest second.

MANUAL WINDING/ SCREW-DOWN CROWN

The motion of your arm during normal daily activities should be sufficient to keep the movement of your automatic chronograph wound. However, if you have not worn it for more than 48 hours and the watch has stopped, you will need to unlock the screw-down crown (select models), and wind the watch by hand before setting the time/date or operating the chronograph functions:

To manually wind your timepiece:

1. On models equipped with a screw-down crown, unlock it by turning it counterclockwise approximately six rotations.
2. With unlocked crown in position I, turn the crown clockwise approximately 20 revolutions to wind the movement.
3. Reset time/date following instructions below.

NOTE: After time/date setting, the screw-down crown found on select models must be screwed back down into the case to ensure water resistance: Press in gently while turning crown clockwise approximately six rotations until you begin to feel resistance. Do not over tighten.

TIME/DATE SETTING

To set the time:

1. Pull crown out to position 3; watch stops.
 2. Turn crown in either direction to move hands to desired time, making sure that the date changes at midnight, not at noon.
- NOTE: The date will advance by one each time midnight is passed when adjusting the time.
3. Push crown back in to position I; watch restarts.

To adjust the date rapidly:

CAUTION: As with all mechanical watches equipped with a calendar feature, never adjust the date rapidly. [with crown in position 2] when the time indicated on the dial is between 9PM (21 :00) and 3AM (03:00); doing so could damage the mechanism.

1. Pull crown out to position 2.
2. Turn crown clockwise to change the date.
3. When correct date is displayed in window J, push crown back in to position I, and screw crown back down.

CHRONOGRAPH FUNCTIONS

Overview:

Use buttons **A** and **B** to operate the chronograph. Pressing button **A** the first time will start the chronograph. While the chronograph is running, the three chronograph counter hands will sweep continuously, indicating the number of currently elapsed seconds (hand **C**), minutes up to 30 (hand **E**), and hours up to 12 (hand **D**). Pressing button **A** a second time will stop the chronograph. Pressing button **B** will reset hands **C**, **E** and **D** to zero.

IMPORTANT: The crown must be in position I, and hands must be at zero before the chronograph is started. If necessary, press button **B** to reset to zero. DO NOT use chronograph while crown is pulled out to position 2 or 3. DO NOT operate chronograph buttons **A** and **B** while timepiece is under water.

NOTE: Hand **S** is the seconds hand for standard timekeeping. It is not part of the chronograph function, and therefore will run continuously while the crown is in position I.

Simple chronograph functions:

1. Press button **A** to start chronograph.
2. Press button **A** a second time to stop chronograph and read elapsed time.
3. Press button **B** to reset chronograph to zero.

Accumulated time functions:

To measure the combined time of a series of shorter events, for example the actual playing time of a football match, where play is repeatedly interrupted:

1. Press button **A** to start chronograph.
2. Press button **A** a second time to stop chronograph and read the elapsed time.



3. Press button **A** again to resume measurement.
4. Press button **A** a fourth time to stop chronograph again and read combined elapsed time.

NOTE: Each time you stop chronograph, chronograph hands will indicate total accumulated time.

5. Repeat steps 1 and 2 to add each additional interval of time.
6. After you have taken your final accumulated time reading, press button **B** to reset chronograph hands to zero.



(11) QUARTZ ANALOG CHRONOGRAPHS 1/1 OF A SECOND – TYPE A

with small chronograph minutes/seconds counters and 24-hour hand

Includes select Heritage and Race Day quartz chronograph models



Figure A

LEGEND

H – Hour hand
M – Minute hand
S – Normal seconds hand
C – Chronograph seconds counter
E – Chronograph minutes counter
F – 24-Hour hand

A – Start/Stop button
B – Reset button

1, 2 – Crown positions

These chronograph models feature a minute counter (up to 30), seconds counter, and small 24-hour hand. They can be used to time an event up to 29 minutes and 59 seconds in duration to the nearest second.

To set the TIME:

1. Pull crown out to position 2; watch (normal seconds hand **S**) stops.
2. Turn crown in either direction to set hour **H** and minute **M** hands to desired time.
3. Push crown back in to position 1; watch (normal seconds hand **S**) restarts.

To operate the CHRONOGRAPH:

This stopwatch is able to measure and display time in 1 second increments up to a maximum of 29 minutes/59 seconds. It will stop automatically after running continuously for 30 minutes.

Simple chronograph functions:

1. Press button **A** to start chronograph.
2. Press button **A** a second time to stop chronograph.
3. Press button **B** to reset chronograph to zero.

Accumulated time functions:

To measure the combined time of a series of shorter events:

1. Press button **A** to start chronograph.
2. Press button **A** a second time to stop chronograph and read elapsed time.
3. Press button **A** again to resume measurement.
4. Press button **A** a fourth time to stop chronograph again, and read new elapsed time.

NOTE: Each time you stop chronograph, chronograph hands will indicate total accumulated time.

5. Repeat steps 1 and 2 to add each additional interval of time.
6. After you have taken your final accumulated time reading, press button **B** to reset chronograph hands to zero.

To RESET Chronograph Hands:

NOTE: Buttons **A** and **B** do not function (as start/stop, reset) during synchronization/resetting of chronograph hands.

After changing the battery, or in the event of an error, the chronograph hands can be re-aligned to zero if necessary:

1. Pull crown out to position 2.
2. Press button **A** to set chronograph seconds hand **C** to zero; press and hold Button **A** to advance hand **C** rapidly.

NOTE: Chronograph minute hand **E** is synchronized automatically with chronograph seconds hand **C**.

3. Once Chronograph hands **C** and **E** have been reset to zero position, reset the time and push crown back into position 1.



(12) QUARTZ ANALOG CHRONOGRAPHS 1/1 OF A SECOND – TYPE B

with small chronograph minutes/seconds counters and 24-hour hand

Includes Paddock quartz chronograph models



Figure A

LEGEND

H – Hour hand
M – Minute hand
S – Normal seconds hand
C – Chronograph seconds counter
E – Chronograph minutes counter
F – 24-Hour hand

A – Start/Stop button
B – Reset button

1, 2 – Crown positions

These chronograph models feature a minute counter (up to 60), seconds counter, and small 24-hour hand. They can be used to time an event up to 59 minutes and 59 seconds in duration to the nearest second.

To set the TIME:

NOTE: Before setting the time, make sure chronograph measurement is stopped and both chronograph hands have been returned to zero position at 12 o'clock.

1. The instant Seconds hand **S** reaches the 12 o'clock position, pull crown out to position 2; watch stops.

NOTE: Do not press button **A** or **B**, otherwise chronograph hands will move.

2. Turn crown in either direction to set Hour **H**, Minute **M** and 24-Hour **F** hands to desired time.

NOTE: 24-hour hand **F** will move in sync with Hour hand **H**, so when setting the hour, make sure 24-hour time is set properly.

3. Take an accurate time signal (from a radio news station, for example). When the audible tone signals the exact time, push crown back in to position 1; watch will restart, now set to the exact time.

To RESET Chronograph Hands:

Before setting the time or running the stopwatch, make sure chronograph counter hands **C** and **E** are in the zero position at 12 o'clock. Follow these steps as needed to reset the counter hands following a battery change or in the event of an error:

1. Pull crown out to position 2.
2. Press button **A** to set Chronograph Seconds hand **C** to zero; to advance hand **C** rapidly, press and hold button **A**.

NOTE: Chronograph Minute hand **E** is synchronized automatically with Chronograph Seconds hand **C**.

3. Once Chronograph hands **C** and **E** have been reset to zero position, reset the time and push crown back into position 1.

Operating the CHRONOGRAPH

This stopwatch is able to measure and display time in 1 second increments up to a maximum of 59 minutes/59 seconds. It will stop automatically after running continuously for 60 minutes. Measured time is indicated by Chronograph Minute **E** and Seconds **C** hands which move independently of the center-mounted and 24-hour watch hands.

Simple chronograph functions:

1. Press button **A** to start chronograph.
2. Press button **A** a second time to stop chronograph.
3. Press button **B** to reset chronograph to zero.

Accumulated time functions:

To measure the combined time of a series of shorter events, for example the actual playing time of a football game, where play is repeatedly interrupted:

1. Press button **A** to start chronograph.
2. Press button **A** a second time to stop chronograph and read elapsed time.
3. Press button **A** again to resume measurement.
4. Press button **A** a fourth time to stop chronograph again, and read new elapsed time.

NOTE: Each time you stop chronograph, chronograph hands will indicate total accumulated time.

5. Repeat steps 1 and 2 to add each additional interval of time.
6. After you have taken your final accumulated time reading, press button **B** to reset chronograph hands to zero.

Split-time or intermediate-time functions:

To take intermediate time readings as a race progresses:

1. Press button **A** to start chronograph.
2. Press button **B** to momentarily stop chronograph and read the intermediate time.
3. Press button **B** to resume chronograph function; the 2 chronograph hands will quickly catch up with ongoing event. Repeat steps 2 and 3 as many times as needed to take additional split times.
4. Press button **A** to stop chronograph, and take a reading of the final time.
5. Press button **B** to reset chronograph hands to zero.



(13) QUARTZ ANALOG CHRONOGRAPHS 1/1 OF A SECOND – TYPE C

with small chronograph minutes/seconds counters, 24-hour hand and date

Includes select Aerodinamico, Gran Premio Quartz, GTB-C and Lap Time quartz chronograph models



Figure A

LEGEND

H – Hour hand
M – Minute hand
S – Normal seconds hand
C – Chronograph seconds counter
E – Chronograph minutes counter
F – 24-Hour hand
D – Date display

A – Start/Stop button
B – Reset button

1, 2, 3 – Crown positions

These chronograph models feature a minute counter (up to 60), seconds counter, small 24-hour hand, and date display. They can be used to time an event up to 59 minutes and 59 seconds in duration to the nearest second.

To set the TIME and DATE:

NOTE: Before setting the time, make sure chronograph measurement is stopped and both chronograph hands have been returned to zero position at 12 o'clock.

1. Pull crown out to position 2.
2. Turn crown clockwise until desired date appears in Display **D**.
3. The instant Seconds hand **S** reaches the 12 o'clock position, pull crown out to position 3; watch stops.

NOTE: Do not press button **A** or **B**, otherwise chronograph hands will move.

4. Turn crown in either direction to set Hour **H**, Minute **M** and 24-Hour **F** hands to desired time, taking AM/PM time into account.

NOTE: 24-hour hand **F** will move in sync with Hour hand **H**, so when setting the hour, make sure 24-hour time is set properly.

5. Take an accurate time signal (from a radio news station, for example). When the audible tone signals the exact time, push crown back in to position 1; watch will restart, now set to the exact time.

To RESET Chronograph Hands:

Before setting the time or running the stopwatch, make sure chronograph counter hands **C** and **E** are in the zero position at 12 o'clock. Follow these steps as needed to reset the counter hands following a battery change or in the event of an error:

1. Pull crown out to position 3.
2. Press button **A** to set Chronograph Seconds hand **C** to zero; to advance hand **C** rapidly, press and hold button **A**.

NOTE: Chronograph Minute hand **E** is synchronized automatically with Chronograph Seconds hand **C**.

3. Once Chronograph hands **C** and **E** have been reset to zero position, reset the time and push crown back into position 1.

Operating the CHRONOGRAPH

This stopwatch is able to measure and display time in 1 second increments up to a maximum of 59 minutes/59 seconds. It will stop automatically after running continuously for 60 minutes. Measured time is indicated by Chronograph Minute **E** and Seconds **C** hands which move independently of the center-mounted and 24-hour watch hands.

Simple chronograph functions:

1. Press button **A** to start chronograph.
2. Press button **A** a second time to stop chronograph.
3. Press button **B** to reset chronograph to zero.

Accumulated time functions:

To measure the combined time of a series of shorter events, for example the actual playing time of a basketball game, where play is repeatedly interrupted:

1. Press button **A** to start chronograph.
2. Press button **A** a second time to stop chronograph and read elapsed time.
3. Press button **A** again to resume measurement.
4. Press button **A** a fourth time to stop chronograph again, and read new elapsed time.

NOTE: Each time you stop chronograph, chronograph hands will indicate total accumulated time.

5. Repeat steps 1 and 2 to add each additional interval of time.
6. After you have taken your final accumulated time reading, press button **B** to reset chronograph hands to zero.

Split-time or intermediate-time functions:

To take intermediate time readings as a race progresses:

1. Press button **A** to start chronograph.
2. Press button **B** to momentarily stop chronograph and read the intermediate time.
3. Press button **B** to resume chronograph function; the 2 chronograph hands will quickly catch up with ongoing event.

Repeat steps 2 and 3 as many times as needed to take additional split times.

4. Press button **A** to stop chronograph, and take a reading of the final time.
5. Press button **B** to reset chronograph hands to zero.



(14) QUARTZ ANALOG CHRONOGRAPHS 1/1 OF A SECOND – TYPE D

with small chronograph minutes counter and 24-hour hand, and date

Includes select D50 and Formula Italia quartz chronograph models

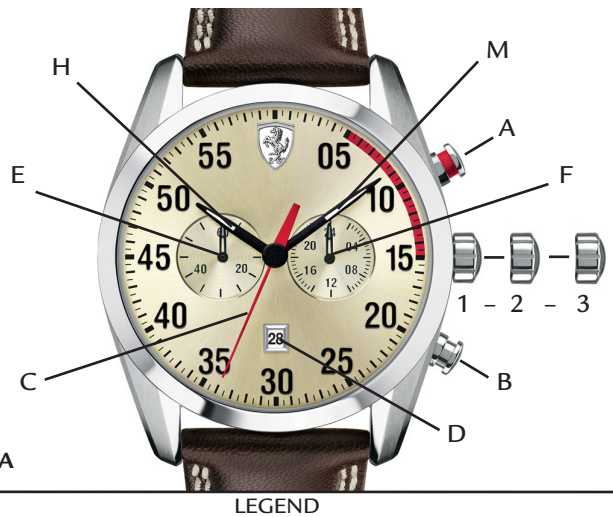

Figure A

LEGEND

H – Hour hand
M – Minute hand
C – Chronograph seconds counter
E – Chronograph minutes counter
F – 24-Hour hand
D – Date display

A – Start/Stop button
B – Reset button

1, 2, 3 – Crown positions

These chronograph models feature a minute counter (up to 60), center-mounted chronograph seconds counter, small 24-hour hand and date display. They can be used to time an event up to 59 minutes and 59 seconds in duration to the nearest second.

To set the TIME:

1. Pull crown out to position 3.
2. Turn crown in either direction to set Hour **H**, Minute **M** and 24-Hour **F** hands to desired time.

NOTE: 24-hour hand **F** will move in sync with Hour hand **H**, so when setting the hour, make sure 24-hour time is set properly.

3. Push crown back in to position 1.

To set the DATE:

1. Pull crown out to position 2.
2. Turn crown clockwise to set date **D**.

IMPORTANT: If date **D** is set when time is between about 9:00 PM and 1:00 AM, the date may not change automatically on the following day.

3. Push crown back in to position 1.

To RESET Chronograph Hands:

Before setting the time or running the stopwatch, make sure chronograph counter hands **C** and **E** are in the zero position at 12 o'clock. Follow these steps as needed to reset the counter hands following a battery change or in the event of an error:

1. Pull crown out to position 2.
2. Press button **A** to set Chronograph Seconds hand **C** to zero; to advance hand **C** rapidly, press and hold button **A**.

NOTE: Chronograph Minute hand **E** is synchronized automatically with Chronograph Seconds hand **C**.

IMPORTANT: Do not push crown back into position 1 while Chronograph Seconds hand **C** is advancing to zero position, or timing mechanism will recognize the position at which hand **C** is stopped as the new zero position.

3. Once Chronograph hands **C** and **E** have been reset to zero position, push crown back into position 1.

Operating the CHRONOGRAPH

This stopwatch is able to measure and display time in 1 second increments up to a maximum of 59 minutes/59 seconds.

Measured time is indicated by Chronograph Minute Counter **E** and Seconds **C** hands.

Simple chronograph functions:

1. Press button **A** to start chronograph.
2. Press button **A** a second time to stop chronograph.
3. Press button **B** to reset chronograph to zero.

Accumulated time functions:

To measure the combined time of a series of shorter events, for example the actual playing time of a football game, where play is repeatedly interrupted:

1. Press button **A** to start chronograph.
2. Press button **A** a second time to stop chronograph and read elapsed time.
3. Press button **A** again to resume measurement.
4. Press button **A** a fourth time to stop chronograph again, and read new elapsed time.

NOTE: Each time you stop chronograph, chronograph hands will indicate total accumulated time.

5. Repeat steps 1 and 2 to add each additional interval of time.
6. After you have taken your final accumulated time reading, press button **B** to reset chronograph hands to zero.



(15) QUARTZ ANALOG CHRONOGRAPHS 1/1 OF A SECOND – TYPE E

with small chronograph minutes/seconds counters, small 24-hour hand (select models), and date

Includes select Aspire, Formula Italia S, Pilota, Pista, Primato, Race Day, Red Rev Evo and Speciale Evo quartz chronograph models



Figure A



Figure B

LEGEND

- H – Hour hand
- M – Minute hand
- S – Normal seconds hand
- C – Chronograph seconds counter
- E – Chronograph minutes counter
- F – 24-Hour hand
- D – Date display

- A – Start/Stop button
- B – Reset button

1, 2, 3 – Crown positions

These chronograph models feature a small minute counter (up to 30), small seconds counter, and date display; some models also have a small 24-hour hand. They can be used to time an event up to 29 minutes and 59 seconds in duration to the nearest second.

Battery end-of-life indicator:

When the battery is almost exhausted, Seconds hand **S** will start to move haltingly in two-second intervals, signaling the need to have the battery replaced as soon as possible. When this happens, the watch will still keep accurate time, however the stopwatch will not operate. If battery end-of-life indication begins while a chronograph measurement is being taken, the timing will stop, and the chronograph hands will reset at their zero position.

To set the TIME and DATE:

NOTE: Before setting the time, make sure chronograph measurement is stopped and both chronograph hands have been returned to zero position at 12 o'clock.

1. Pull crown out to position 2.
2. Turn crown counterclockwise until previous day's date appears in Display **D**.

NOTE: Do not set date when the time is between 9:00 PM and 1:00 AM, otherwise the date may not change automatically on the following day.

3. The instant Seconds hand **S** reaches the 12 o'clock position, pull crown out to position 3; watch stops.

NOTES: If the crown is pulled out to position 3 while the chronograph is running, the stopwatch function will stop automatically, and the hands will reset to zero. When crown is in position 3, it may be turned clockwise or counterclockwise to move Hour **H** and Minute **M** hands in either direction.

4. Turn crown clockwise advancing Hour **H** and Minute **M** hands past 12:00 midnight to advance Date **D** to current date; then continue turning crown clockwise to set Hour **H**, Minute **M** and 24-Hour **F** hands to desired time, taking AM/PM time into account.

NOTES: 24-hour hand **F**, found on select models only, will move in sync with Hour hand **H**, so when setting the hour, make sure 24-hour time is set properly.

RECOMMENDATION: When setting Minute hand **M**, first advance it 4 to 5 minutes ahead of desired time, then turn it back to the exact minute.

5. Take an accurate time signal (from a radio news station, for example). When the audible tone signals the exact time, push crown back in to position 1; watch will restart, now set to the exact time.

To RESET Chronograph Hands:

Before setting the time or running the stopwatch, make sure chronograph counter hands **C** and **E** are in the zero position at 12 o'clock. Follow these steps as needed to reset the counter hands following a battery change or in the event of an error:

1. Pull crown out to position 3.
- NOTE: If the chronograph is running or has been stopped while running, when the crown is pulled out to position 3, the stopwatch hands will be automatically reset.
2. Press button **A** to move stopwatch hands **C** and **E** clockwise.
3. Press button **B** to move stopwatch hands **C** and **E** counterclockwise.

NOTES: To move the hands quickly in desired direction, press and hold button **A** or button **B**. Minute hand **E** is synchronized automatically with Seconds hand **C**. To reset hand **E**, continue to move hand **C** until hand **E** reaches the zero position.

4. Once Chronograph hands **C** and **E** have been reset to zero position, push crown back into position 1.



Operating the CHRONOGRAPH

This stopwatch is able to measure and display time in 1 second increments up to a maximum of 29 minutes/59 seconds. It will stop automatically after running continuously for 30 minutes. Measured time is indicated by Chronograph Minute **E** and Seconds **C** hands which move independently of the center-mounted and 24-hour watch hands.

Simple chronograph functions:

1. Press button **A** to start chronograph.
2. Press button **A** a second time to stop chronograph.
3. Press button **B** to reset chronograph to zero.

Accumulated time functions:

To measure the combined time of a series of shorter events, for example the actual playing time of a basketball game, where play is repeatedly interrupted:

1. Press button **A** to start chronograph.
2. Press button **A** a second time to stop chronograph and read elapsed time.
3. Press button **A** again to resume measurement.
4. Press button **A** a fourth time to stop chronograph again, and read new elapsed time.

NOTE: Each time you stop chronograph, chronograph hands will indicate total accumulated time.

5. Repeat steps 1 and 2 to add each additional interval of time.
6. After you have taken your final accumulated time reading, press button **B** to reset chronograph hands to zero.

Split-time functions:

To take intermediate time readings as a race progresses:

1. Press button **A** to start chronograph.
2. Press button **B** to momentarily stop chronograph and read the intermediate time.
3. Press button **B** to resume chronograph function; the 2 chronograph hands will quickly catch up with ongoing event.

Repeat steps 2 and 3 as many times as needed to take additional split times.

4. Press button **A** to stop chronograph, and take a reading of the final time.
5. Press button **B** to reset chronograph hands to zero.

Timing two competitors simultaneously:

To measure the finish times of two racers, for example:

1. Press button **A** to start chronograph.
2. Press button **B** to read the finish time of the first competitor.
3. As soon as second competitor crosses the finish line, press button **A**.
4. Press button **B** to read finish time of the second competitor.
5. Press button **B** again to reset chronograph hands to zero.



(16) QUARTZ ANALOG CHRONOGRAPHS 1/4 OF A SECOND

with center-mounted chronograph quarter-of-a-second hand, small chronograph minutes counter and seconds hand, and date

Includes Formula Sportiva quartz chronograph models



H – Hour hand
M – Minute hand
S – Small seconds hand
C – Chronograph 1/4-of-a-second hand
E – Chronograph minutes counter
D – Date display

A – Start/Stop button
B – Reset button

1, 2, 3 – Crown positions

These chronograph models feature a center-mounted chronograph 1/4-of-a-second hand, small minute counter, small seconds hand and date display. They can be used to time an event up to 60 minutes in duration to the nearest quarter of a second.

To set the TIME:

1. Pull crown out to position 2; watch (small seconds hand **S**) stops.
2. Turn crown clockwise to set hour **H** and minute **M** hands to desired time.
3. Push crown back in to position 1; watch (small seconds hand **S**) restarts.

To set the DATE:

1. Pull crown out to position 2.
 2. Turn crown clockwise to set date **D**.
- IMPORTANT: If date **D** is set when time is between about 9:00 PM and 1:00 AM, the date may not change automatically on the following day.
3. Push crown back in to position 1.

To operate the CHRONOGRAPH:

This chronograph is able to measure and display time in 1/4-second increments up to a maximum of 60 minutes. It will stop automatically after running continuously for 60 minutes.

Simple chronograph functions:

1. Press button **A** to start chronograph.
2. Press button **A** a second time to stop chronograph.
3. Press button **B** to reset chronograph to zero.

Accumulated time functions:

To measure the combined time of a series of shorter events:

1. Press button **A** to start chronograph.
2. Press button **A** a second time to stop chronograph and read elapsed time.
3. Press button **A** again to resume measurement.
4. Press button **A** a fourth time to stop chronograph again, and read new elapsed time.

NOTE: Each time you stop chronograph, chronograph hands will indicate total accumulated time.

5. Repeat steps 1 and 2 to add each additional interval of time.
6. After you have taken your final accumulated time reading, press button **B** to reset chronograph hands to zero.

To RESET Chronograph Hands:

After changing the battery, or in the event of an error, the chronograph hands can be re-aligned to zero if necessary by following these steps:

1. Pull crown out to position 3.
 2. Press button **A** to set chronograph 1/4-of-a-second hand **C** to zero; to advance hand **C** rapidly, press and hold button **A**.
- NOTE: Chronograph minute hand **E** is synchronized automatically with chronograph 1/4-of-a-second hand **C**.
3. Once chronograph hands **C** and **E** have been reset to zero position, reset the time and push crown back into position 1.



(17) QUARTZ ANALOG CHRONOGRAPHS 1/5 OF A SECOND – TYPE A

with center-mounted chronograph fifths-of-a-second hand, small chronograph minutes counter, and small seconds and 24-hour hands

Includes select Heritage, Race Day and Scuderia quartz chronograph models



Figure A

LEGEND

- H – Hour hand
- M – Minute hand
- S – Small seconds hand
- C – Chronograph 1/5-of-a-second hand
- E – Chronograph minutes counter
- F – 24-Hour hand
- D – Date display

- A – Start/Stop button
- B – Reset button

- 1, 2, 3 – Crown positions

These chronograph models feature a center-mounted fifths-of-a-second chronograph hand, minute counter (up to 60), small seconds and 24-hour hands, and date. They can be used to time an event up to 60 minutes in duration to the nearest 1/5 of a second.

To set the TIME:

1. Pull crown out to position 3; watch (small seconds hand S) stops.
NOTE: If crown is pulled to position 3 while chronograph is running, timing will continue and chronograph hands C and E will continue to move.
2. Turn crown in either direction to set hour H and minute M hands to desired time taking AM/PM into account.
3. Push crown back in to position 1; watch restarts.

To set the DATE:

1. Pull crown out to position 2.
2. Turn crown clockwise to set date D.

CAUTION: Do not set date D when hour and minute hands are between 9:00 PM and 3:00 AM; doing so could damage the calendar mechanism. If you must reset date during those hours, first move hour and minute hands to any time outside that period, reset the date, and then reset hands to correct time.

3. Push crown back in to position 1.

To operate the CHRONOGRAPH:

This chronograph is able to measure and display time in 1/5-of-a-second increments up to a maximum of 60 minutes. It will stop automatically after reaching 60 minutes.

Simple chronograph functions:

1. Press button A to start chronograph; chronograph hands C and E start moving.
2. Press button A a second time to stop chronograph; read elapsed time indicated by hands C and E.
3. Press button B to reset chronograph hands to zero.

Accumulated time functions:

To measure the combined time of a series of shorter events, for example the actual playing time of a football game, where play is repeatedly interrupted:

1. Press button A to start chronograph.
2. Press button A a second time to stop chronograph and read elapsed time.
3. Press button A again to resume measurement.
4. Press button A a fourth time to stop chronograph again, and read new elapsed time.

NOTE: Each time you stop chronograph, chronograph hands will indicate total accumulated elapsed time.

5. Repeat steps 1 and 2 to add each additional interval of time.
6. After you have taken your final accumulated time reading, press button B to reset chronograph hands to zero.

To RESET Chronograph Hands:

If the chronograph hand positions are incorrect, the hands can be realigned to zero by pressing button A once to start the chronograph, pressing button A a second time to stop the chronograph, and then pressing button B to return both chronograph hands to zero.



(18) QUARTZ ANALOG CHRONOGRAPHS 1/5 OF A SECOND – TYPE B

with center-mounted chronograph fifths-of-a-second hand, small chronograph hours/minutes counters, small seconds hand, and date

Includes select Cronometro, Lap Time, Race Day and Ready-Set-Go quartz chronograph models

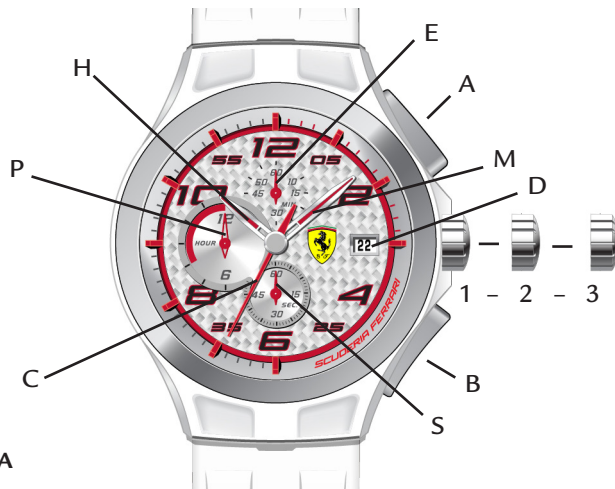

Figure A

LEGEND

H – Hour hand
M – Minute hand
S – Small seconds hand
C – Chronograph 1/5-of-a-second hand
E – Chronograph minutes counter
P – Chronograph hours counter
D – Date display

A – Start/Stop button
B – Reset button

1, 2, 3 – Crown positions

These chronograph models feature a center-mounted fifths-of-a-second chronograph hand, hour counter (up to 12), minute counter (up to 60), small seconds hand, and date. They can be used to time an event up to 12 hours in duration to the nearest 1/5 of a second.

To set the TIME:

1. Pull crown out to position 3; watch (small seconds hand **S**) stops.
NOTE: If crown is pulled to position 3 while chronograph is running, timing will continue and chronograph hands **C**, **E** and **P** will continue to move.
2. Turn crown in either direction to set hour **H** and minute **M** hands to desired time taking AM/PM into account.
3. Push crown back in to position 1; watch restarts.

To set the DATE:

1. Pull crown out to position 2.
2. Turn crown clockwise to set date **D**.

CAUTION: Do not set date **D** when hour and minute hands are between 9:00 PM and 3:00 AM; doing so could damage the calendar mechanism. If you must reset date during those hours, first move hour and minute hands to any time outside that period, reset the date, and then reset hands to correct time.

3. Push crown back in to position 1.

To operate the CHRONOGRAPH:

This chronograph is able to measure and display time in 1/5-of-a-second increments up to a maximum of 12 hours. It will stop automatically after reaching 12 hours.

Simple chronograph functions:

1. Press button **A** to start chronograph; chronograph hands **C**, **E** and **P** start moving.
2. Press button **A** a second time to stop chronograph; read elapsed time indicated by hands **C**, **E** and **P**.
3. Press button **B** to reset chronograph hands to zero.

Accumulated time functions:

To measure the combined time of a series of shorter events, for example the actual playing time of a football game, where play is repeatedly interrupted:

1. Press button **A** to start chronograph.
2. Press button **A** a second time to stop chronograph and read elapsed time.
3. Press button **A** again to resume measurement.
4. Press button **A** a fourth time to stop chronograph again, and read new elapsed time.

NOTE: Each time you stop chronograph, chronograph hands will indicate total accumulated elapsed time.

5. Repeat steps 1 and 2 to add each additional interval of time.
6. After you have taken your final accumulated time reading, press button **B** to reset chronograph hands to zero.

To RESET Chronograph Hands:

If the chronograph hand positions are incorrect, the hands can be realigned to zero by pressing button **A** once to start the chronograph, pressing button **A** a second time to stop the chronograph, and then pressing button **B** to return all three chronograph hands to zero.



(19) QUARTZ ANALOG CHRONOGRAPHS 1/5 OF A SECOND – TYPE C

with center-mounted chronograph fifths-of-a-second hand, small chronograph 30-minutes counter, and small seconds and date indicator hands

Includes Scuderia XX Swiss quartz chronograph models



H – Hour hand
M – Minute hand
S – Small seconds hand
C – Chronograph 1/5-of-a-second hand
E – Chronograph 30 minutes counter
J – Date indicator hand
D – Date window

A – Start/Stop button
B – Reset button

1, 2, 3 – Crown positions

These chronograph models feature a center-mounted fifths-of-a-second chronograph hand, a minute counter (up to 30), small seconds and date indicator hands, and date window. They can be used to time an event up to 120 minutes in duration to the nearest 1/5 of a second.

To set the TIME:

1. Pull crown out to position 3; watch (small seconds hand **S**) stops. NOTE: If crown is pulled to position 3 while chronograph is running, timing will stop.
2. Turn crown in either direction to set hour **H** and minute **M** hands to desired time taking AM/PM into account.
3. Push crown back in to position 1; watch restarts.

To set the DATE:

1. Pull crown out to position 2.
 2. Turn crown clockwise to set date **D**.
- NOTE: Date indicator hand **J** will automatically advance to match date shown in window **D**.
- CAUTION: Do not set date **D/J** when hour and minute hands are between 9:00 PM and 12:30 AM; doing so could damage the calendar mechanism. If you must reset date during those hours, first move hour and minute hands to any time outside that period, reset the date, and then reset hands to correct time.
3. Push crown back in to position 1.

To operate the CHRONOGRAPH:

This chronograph is able to measure and display time in 1/5-of-a-second increments up to a maximum of 2 hours (4 revolutions of the 30-minute counter). To save battery life, the chronograph will stop and reset automatically after 2 hours of continuous running.

Simple chronograph functions:

1. Press button **A** to start chronograph; chronograph hands **C** and **E** start moving.
2. Press button **A** a second time to stop chronograph; read elapsed time indicated by hands **C** and **E**.
3. Press button **B** to reset chronograph hands to zero.

Accumulated time functions:

To measure the combined time of a series of shorter events, for example the actual playing time of a football game, where play is repeatedly interrupted:

1. Press button **A** to start chronograph.
2. Press button **A** a second time to stop chronograph and read elapsed time.
3. Press button **A** again to resume measurement.
4. Press button **A** a fourth time to stop chronograph again, and read new elapsed time.

NOTE: Each time you stop chronograph, chronograph hands will indicate total accumulated elapsed time.

5. Repeat steps 1 and 2 to add each additional interval of time.
6. After you have taken your final accumulated time reading, press button **B** to reset chronograph hands to zero.

Split-time or intermediate-time functions:

To take intermediate time readings as a race progresses:

1. Press button **A** to start chronograph.
2. Press button **B** to momentarily stop chronograph.
3. Read off the intermediate time, for example: 11 minutes, 16 seconds.
4. Press button **B** to resume chronograph function. The 2 chronograph hands will quickly catch up with ongoing event.
5. To read a second split time, press button **B** again. Repeat steps 2 through 4 to take any additional split times.
6. Press button **A** to stop chronograph.
7. Take a reading of the final time, for example: 24 minutes, 7.2 seconds.
8. Press button **B** to reset chronograph hands to zero.

To RESET Chronograph Hands:

After changing the battery, or in the event of an error, the chronograph hands can be realigned to zero if needed:

NOTE: To advance hands rapidly, press push buttons and hold longer than one second.

Crown position 2:

Adjust minute-counter hand **E** using button **B**.

Crown position 3:

Adjust chronograph fifths-of-a-second hand **C** using button **A**.



(20) QUARTZ ANALOG CHRONOGRAPHS 1/10 OF A SECOND

with small chronograph minutes/seconds counter and chronograph tenths of a second counter

Includes Speedracer quartz chronograph models



Figure A

LEGEND

- 1, 2, 3** – Crown positions
Button A – Start/Stop
Button B – Reset
H – Hour hand
M – Minute hand
S – Second hand
P – Chronograph Minutes hand
Q – Chronograph Seconds hand
X – Chronograph 1/10-of-a-seconds Chronograph hand

Crown Positions:

Position 1 - Normal running position; crown pushed into case.

Position 2 - To set TIME: if no date function.

To set DATE: applicable with date function.

Position 3 - To set TIME: applicable with date function.

The time measured indicated by the stopwatch hands is independent from the center hands.

The stopwatch can measure up to 60 minutes.

The stopwatch measures in 1/10 second increments.

To set the time:

1. Pull crown out to position 2 when the second hand is at the 12 o'clock position, watch stops.
2. Turn crown in either direction to move hands to desired time. If applicable for your model, make sure to respect **AM/PM**. Do not press any button, otherwise the chronograph hands will move.
3. Push crown back in to position 1; watch restarts, now set to correct time.

To set the date (if applicable):

If your watch has a date window, your crown will have 3 positions. Position 2 is used to set the date:

1. Pull crown out to position 2.
2. Turn crown clockwise until the correct date appears.

Crown Position 3 is used to set the time as per above explanation.

Simple Chronograph Functions:

To measure the duration of a single, non-stop event (up to 60 minutes):

1. Press button **A** to start chronograph.
2. Press button **A** a second time to stop chronograph.
3. Press button **B** to reset chronograph hands to zero.

Measuring Cumulative Times:

1. Press button **A** to start chronograph.
2. Press button **A** to stop chronograph timing.
3. Press button **A** to restart.
4. Repeat steps 2 and 3 as many times as desired.
5. When through timing, press button **B** to reset chronograph hands to zero.

Measuring Split Times:

1. Press button **A** to start chronograph.
2. Press button **B** to momentarily stop chronograph and read an intermediate or split time.
3. Press button **B** to restart; chronograph hands will advance rapidly to catch up with ongoing event.
4. Repeat steps 2 and 3 to take as many intermediate or split times as desired.
5. Press button **A** to stop chronograph timing.
6. Press button **B** to reset chronograph hands to zero.



(21) QUARTZ ANALOG-DIGITAL CHRONOGRAPH MODELS – TYPE A

with alarm function

Includes Lap Time quartz Ana-Digi models



Figure A

LEGEND

H – Analog Hour hand
M – Analog Minute hand
S – Analog Seconds hand

E – Upper Digital display – Mode/Calendar
F – Lower Digital display – Time/Setting
G – Chime ON Indicator
K – Alarm ON Indicator

A – EL Backlight button
B – Mode Selection button
C – Setting Mode button
D – Start/Stop button

1, 2 – Crown positions

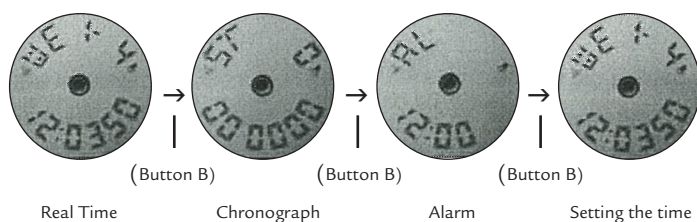

This analog-digital model features analog Hour, Minute and Seconds hands, and upper/lower LCD digital display with Calendar/Real Time in 12-hour or 24-hour format, Alarm and Chronograph functions, and EL backlight.

To select MODE:

Press button **B** to cycle through the Modes in this order: REAL TIME → CHRONOGRAPH → ALARM → TIME SETTING → REAL TIME.

To use EL Backlight: Press button **A** at any time to illuminate the dial for 3 seconds to make reading digital display possible in low light conditions.

TIME SETTING

To set Digital TIME:

1. Press button **B** three times to advance to TIME Setting Mode; Seconds display will blink.
2. Press button **D** to reset Seconds to 00.
3. Use button **C** to advance through TIME Setting Sequence in this order: HOUR → MINUTE → MONTH → DATE → DAY OF WEEK → SECONDS. The active digital field in current Setting Mode will blink.
4. Press button **D** to adjust blinking number.
5. Press button **C** to confirm new setting and advance to next field in setting sequence.
6. Repeat steps 4 and 5 to complete TIME Setting sequence.
7. When finished, press button **B** to exit TIME Setting mode.

NOTES: When setting the Time, “H” is displayed for 24-hour format, and “A” or “P” for 12-hour format.

To select 12- or 24-hour format, press and hold button **C**: The display will cycle through time formats in this sequence: “A” (AM) time → “P” (PM) time → “H” (24H) time → “A” (AM) time.

If you press **D** while Seconds display reads 30 to 59, Seconds are reset to 00 and Time is set to next Minute; if you press **D** while Seconds display reads 00 to 29, Minute does not change.

To set Analog TIME:

1. Pull crown out to position 2.
2. Rotate crown in either direction until hands indicate desired time.
3. Press crown back in to position 1, flush against case.

CHRONOGRAPH

In this Mode, watch functions like a stopwatch to measure intervals of time.

NOTE: You can return to Real Time mode while Chronograph is running by pressing button **B**.

To operate CHRONOGRAPH:

From Real Time Mode, press button **B** once to enter CHRONOGRAPH Mode; use buttons **C** and **D** to operate the Chronograph.

To measure the duration of a single, non-stop event:

1. Press button **D** to start timing.
2. Press button **D** a second time to stop timing; read elapsed time in Lower digital display.
3. Press button **C** to reset display to zero.

To measure the combined time of a series of shorter events:

1. Press button **D** to start timing.
2. Press button **D** a second time to stop timing and read elapsed time in Lower digital display.
3. Press button **D** again to resume measurement.
4. Press button **D** a fourth time to stop chronograph again, and read new elapsed time.

NOTE: Each time you stop timing, digital display will indicate total accumulated time.

5. Repeat steps 3 and 4 to add additional intervals of time, as needed.



6. After you have taken your final accumulated time reading, press button **C** to reset display to zero.

To take an intermediate or split-time time readings as an event progresses:

1. Press button **D** to start timing.
2. Press button **C** to read intermediate or split time in Lower digital display; CHRONOGRAPH continues to keep timing event in background.

NOTE: When split-time function is activated, the indicator "SP" will appear in Upper digital display.

3. Press button **C** to resume event timing; Lower digital display advances to show current timing of ongoing event.
4. Repeat steps 2 and 3 to take any additional split times.
5. Press button **D** to stop timing at end of event; and read final time in Lower digital display.
6. Press button **C** and read final time in Lower digital display.
7. Press button **C** to reset Chronograph to zero.

DAILY ALARM

Watch may be set to sound a CHIME and/or ALARM.

To activate/deactivate ALARM:

1. From Real Time Mode, press button **B** twice to enter ALARM Mode.
2. Press button **D** one or more times to turn ALARM [•••••] and/or CHIME [🔔] ON or OFF in this sequence:

ALARM ON → CHIME ON → ALARM and CHIME ON → ALARM and CHIME OFF.

When ALARM and/or CHIME are activated, their icon(s) will appear in the Upper digital display.

To set the ALARM:

1. From Real Time Mode, press button **B** twice to enter ALARM Mode.
2. Press button **C**; Hours will blink.
3. Press button **D** to adjust the blinking number in HOUR field.
4. When correct number appears in blinking display, press button **C** to confirm HOUR setting; Minutes will blink.
5. Press button **D** to adjust the blinking number in MINUTES field.
6. When correct number appears in blinking display, press button **C** to confirm MINUTES setting.
7. Press button **B** to return to Real Time mode.

To use the Snooze feature:

When ALARM sounds, press button **D** to turn sound OFF; then press button **B** to activate or deactivate the SNOOZE feature. When the Snooze feature is turned ON, the ALARM will sound again 5 minutes later. If no button is pushed, the ALARM will stop sounding automatically after 20 seconds.



(22) QUARTZ ANALOG-DIGITAL CHRONOGRAPH MODELS – TYPE B

with alarm function

Includes Aerodinamico and Aero Evo quartz Ana-Digi models



Figure A

LEGEND

H – Analog Hour hand
M – Analog Minute hand
S – Analog Seconds hand

E – Digital display
K – Alarm ON Indicator

A – Reset button
B – Mode Selection button
C – EL Backlight button
D – Start/Stop button

1, 2 – Crown positions

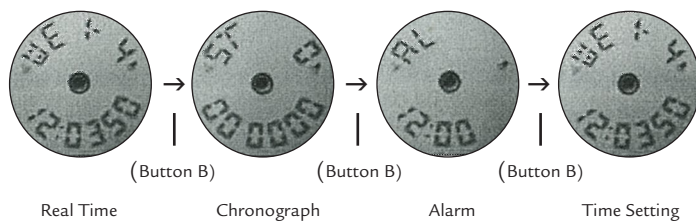

This analog-digital chronograph features analog Hour, Minute and Seconds hands, and a 6-digit LCD digital display (Hour, Minute, Second, Month, Day) with Calendar/Real Time in 12-hour or 24-hour format, daily Alarm with Snooze feature, 1/100 Chronograph split-time function, and EL backlight. It may be used to time an event up to 23 hours, 59 minutes, 59.99 seconds in duration to the nearest 0.01 second.

To select MODE:

Press button **B** to cycle through the Modes in this order:

REAL TIME → CHRONOGRAPH → ALARM → TIME SETTING → REAL TIME.

To use EL Backlight: Press button **C** at any time to illuminate the dial for 3 seconds to make reading digital display possible in low light conditions.

From Real Time Mode:

Press button **A** to display Alarm setting.

Press button **D** to display Date.

Press buttons **A** and **D** simultaneously to turn Alarm ON or OFF.

When Alarm is activated, a small bell symbol [] will appear in upper right of digital display.

TIME SETTING

To set Digital TIME:

1. Press button **B** three times to advance to TIME Setting Mode; Seconds display will blink.
 2. Press button **D** to reset Seconds to 00.
 3. Use button **A** to advance through TIME Setting Sequence in this order: MINUTE → HOUR → DAY → MONTH. The active digital field in current Setting Mode will blink.
 4. Press button **D** to adjust blinking number.
 5. Press button **A** to confirm new setting and advance to next field in setting sequence.
 6. Repeat steps 4 and 5 to complete TIME Setting sequence.
- NOTES: When setting the Hour, "H" is displayed for 24-hour format, and "A" or "P" for 12-hour format.

To select 12- or 24-hour format, press and hold button **D**: The display will cycle through time formats in this sequence: "A" (AM) time → "P" (PM) time → "H" (24H) time → "A" (AM) time. If you press **D** while Seconds display reads 30 to 59, Seconds are reset to 00 and Time is set to next Minute; if you press **D** while Seconds display reads 00 to 29, Minute does not change.

To set Analog TIME:

1. Pull crown out to position 2.
2. Rotate crown in either direction until hands indicate desired time.
3. Press crown back in to position 1, flush against case.

CHRONOGRAPH

In this Mode, watch functions like a stopwatch to measure intervals of time to the nearest 0.01 second for the first 30 minutes; to the nearest 1.0 second from 30 minutes to 24 hours.

NOTE: You can return to Real Time mode while Chronograph is running by pressing button **B**.

To operate CHRONOGRAPH:

From Real Time Mode, press button **B** once to enter CHRONOGRAPH Mode; use buttons **D** and **A** to operate the CHRONOGRAPH.

To measure the duration of a single, non-stop event:

1. Press button **D** to start timing.
2. Press button **D** a second time to stop timing; read elapsed time in digital display.
3. Press button **A** to reset display to zero.



To take intermediate or split-time time readings as an event progresses:

1. Press button **D** to start timing.
2. Press button **A** to read intermediate or split time in digital display; CHRONOGRAPH continues to keep timing event in background.
3. Press button **A** to resume event timing; digital display advances to show current timing of ongoing event.
4. Repeat steps 2 and 3 to take any additional split times.
5. Press button **D** to stop timing at end of event; and read final time in digital display.
6. Press button **A** again to reset CHRONOGRAPH to zero.

NOTE: While CHRONOGRAPH is running, you may press button **B** to return to Real Time Mode; CHRONOGRAPH will continue timing in background.

DAILY ALARM

To set the ALARM:

1. From Real Time Mode, press button **B** twice to enter ALARM Mode; Hours will blink.
2. Press button **A** to toggle between and select field to be set: Hours or Minutes.
3. Press button **D** to adjust the blinking number in selected field.
4. When correct number appears in blinking display, press button **A** to confirm setting.
5. When finished with ALARM setting, press button **B** to return to Real Time mode.

To activate/deactivate ALARM:

In Real Time Mode, press buttons **A** and **D** simultaneously to turn Alarm ON or OFF. When Alarm is activated, a small bell symbol [🔔] will appear in upper right of digital display.

To use Snooze feature:

When ALARM sounds, press button **A** to turn sound OFF; then press button **D** to activate or deactivate the Snooze feature.

When Snooze feature is turned ON, the ALARM will sound again 5 minutes later.

If no button is pushed, the ALARM will stop sounding automatically after 1 minute.



(23) AUTOMATIC WORLDTIME MODELS

with city time zone indication

Includes select Gran Premio limited edition Swiss automatic models



H – Hour hand
M – Minute hand
S – Seconds hand
D – Date display
W – City indicator
T – Time zone indicator

A – Time Zone City Selector button
B – Time Zone Corrector button

1, 2, 3 – Crown positions

These limited edition Worldtime models feature a fine 21-jewel Swiss automatic movement with unique World Cities/Second Time Zone Indication and 42-hour power reserve.

CAUTION: Do not pull the crown out or push the buttons while the watch is underwater.

To WIND the movement by hand:

The motion of your arm during normal daily activities should be sufficient to keep the movement of your automatic timepiece wound. However, if you have not worn your watch for 42 hours or more, and the watch has stopped, you will need to wind it by hand before setting the time:

1. With the crown in position 1, turn the crown clockwise approximately 20 revolutions.
2. Reset the Time following instructions below.

To set the TIME:

1. Pull crown out to position 3; watch (seconds hand **S**) stops.
2. Turn crown in either direction to set hour **H** and minute **M** hands to desired time.
3. Push crown back in to position 1; watch restarts.

To set the DATE:

Quick Setting:

CAUTION: Never use Quick Date Setting when the time is between 8:00 PM and 1:00 AM and automatic calendar changes are already in progress. Doing so could damage the mechanism.

1. Pull crown out to position 2; watch (seconds hand **S**) continues to run.
2. Turn crown counterclockwise to adjust Date in window **D**.
3. Push crown back in to position 1.

Slow Setting:

To ensure that the Date changes at midnight and not at noon:

1. Pull crown out to position 3.
2. Turn crown clockwise, advancing Hour **H** and Minute **M** hands past midnight repeatedly until correct Date appears in window **D**, then continue turning crown clockwise to move hands to desired time.
3. Push crown back in to position 1.

To set the Time Zone City:

Press button **A** until desired World City name appears in center of City Indicator display **W**.

NOTE: To advance cities rapidly press and hold button **A**.

To set the Time Zone Number:

Press button **B** until desired number appears in center of Time Zone Indicator display **T**.

NOTE: To advance numbers rapidly, press and hold button **B**.



(24) AUTOMATIC BI-RETROGRADE SKELETON MODELS

Includes F14-R limited edition Swiss automatic models



Figure A

LEGEND

H - Hour hand
M - Minute hand
D - Retrograde Date indicator
W - Retrograde Day indicator

A - Date Corrector button
B - Day Corrector button

1, 2 - Crown positions

These limited edition bi-retrograde models feature a fine 29-jewel Swiss automatic skeletonized movement with wedge-shaped retrograde Day and Date displays and 44-hour power reserve.

To WIND the movement by hand:

The motion of your arm during normal daily activities should be sufficient to keep the movement of your automatic timepiece wound. However, if you have not worn your watch for 44 hours or more, and the watch has stopped, you will need to wind it by hand before setting the time:

1. With the crown in position 1, turn the crown clockwise approximately 20 revolutions.
2. Reset the Time following instructions below.

Crown Positions:

Position 1 - Normal/hand-winding position; flush against case.

Position 2 - To set TIME: Rotate crown in either direction.

Corrector Buttons:

Use the corrector tool included with your watch, or a similar pointed object such as the tip of a pen, to depress recessed corrector buttons located on the sides of the case:

Button **A** - Press to manually correct/advance Retrograde Date **D**

Button **B** - Press to manually correct/advance Retrograde Day **W**



(25) DIGITAL TOUCH-SCREEN MODELS

with LED dual-time zone and month/date display

Includes Aero Touch digital quartz models



Figure A



Figure B

LEGEND

- LED** - Main Digital Display
T1 - Time Zone 1 Mode Indicator
T2 - Time Zone 2 Mode Indicator
DA - Date Mode Indicator
P - PM Indicator (appears in Setting Mode only)

Touch regions

- A** - ON/OFF
B - SET
C - SWIPE
D - SWIPE

These dual-time digital watch models feature an innovative touch screen 4-Digit LED display with 3-mode function: TIME1, TIME2 and DATE. In the Main LED display, the TIME Modes are shown in 12-hour format; the DATE Mode appears in Month/Date format. One of three smaller LED displays beneath the Main one indicates which Mode is active. The touch-screen crystal is specially treated to resist fingerprints/smudging.

The crystal over the dial has four touch regions or quadrants:

A - Touch near 12 o'clock to turn the watch ON or OFF.

B - Touch near 6 o'clock to SET the active display.

C/D -Swipe your finger horizontally in either direction to move from one display MODE to another:

Mode sequence:

TIME1 ↔ **TIME2** ↔ **DATE**
 (Hour/Minutes) (Hour/Minutes) (Month/Date)

Operating the Watch/Touch-Screen:

- To turn your watch ON, touch the Racing Shield in region **A**, maintaining contact for about 2 seconds until the LED display lights up. TIME1 will automatically display at start-up.
 NOTE: Once ON, whenever the touch screen idles (is not touched) for 5 seconds, the watch will go into Sleep Mode, and the LED display will go dark, conserving battery power: Touch any region to wake up the LED display.
- To move between the 3 Display Modes, swipe your finger across regions **C** and **D** in either direction.
- To turn the watch OFF, touch the Racing Shield in region **A** for about 2 seconds until the LED displays the word "bye", then goes dark.

NOTE: If the 5-second LED display is activated five times a day, battery life expectancy is 24 months. More frequent operation will decrease battery life.

Setting the Time/Date:

You may enter the Setting Mode from any of the 3 Display Modes - TIME1, TIME2 or DATE:

- To enter Setting Mode, touch region **B**, maintaining contact for about 2 seconds until the first 2 digits in the active LED Display Mode start to blink.
 NOTE: While the display is blinking, if the screen idles (is not touched) for 10 seconds, the watch will exit Setting Mode and return to normal Display Mode: Repeat step one to re-enter Setting Mode.
- Swipe your finger across the screen from region **C** to **D** to increase the blinking number, or from region **D** to **C** to decrease it.
- To confirm the new blinking setting for Hour or Month, touch region **B** for about 1.5 seconds until the first 2 digits stop blinking, and the second 2 digits start blinking.
- Swipe your finger across the screen from region **C** to **D** to increase the blinking number, or swipe from region **D** to **C** to decrease it.
- To confirm the new blinking setting for Minutes or Date, touch region **B** for about 1.5 seconds until the second 2 digits stop blinking, and watch exits Setting Mode.

NOTE: "P" indicating PM time and "Year" will only be displayed while the watch is in Setting Mode (for Time or Date, respectively); they will not appear in TIME1, TIME2 or DATE Display Mode.



(26) ANALOG/DIGITAL TRIPLE-MOVEMENT MODELS

with analog 2-hand, analog 3-hand, and digital LED time/date movements

Includes XX Kers special edition models



Figure A

LEGEND

- G1** - Gauge 1 / Analog 3-hand subdial
- G2** - Gauge 2 / Analog 2-hand subdial
- G3** - Gauge 3 / Digital time/date subdial

- A** - G1 setting crown
- B** - G2 setting crown
- C** - G3 setting corrector button
- D** - G3 setting adjuster button

A highly functional, distinctive tool for the world traveler, this time-piece features a dial defined by 3 “gauges” that can be set to report the time in three separate time zones; the digital “gauge” can be adjusted to display time, date or current seconds.

To set the TIME in G1:

1. When the seconds hand in **G1** reaches 12 o'clock, gently pull crown **A** out; seconds hand stops.
2. Turn crown **A** in either direction to set hour and minute hands in **G1** to desired time.
3. Push crown **A** back in to position 1; small seconds hand restarts.

To set the TIME in G2:

1. Gently pull crown **B** out.
2. Turn crown **B** in either direction to set hour and minute hands in **G2** to desired time.
3. Push crown **B** back in to position 1.

To set the TIME/DATE in G3:

To set the digital display information in **G3**, use a watch corrector tool or similar object with a narrow pointed end to press recessed corrector button **C**:

1. Press corrector **C** twice to activate Month setting.
2. Press button **D** to adjust month displayed.
3. Press corrector **C** to set Month and activate Day setting.
4. Press button **D** to adjust day displayed.
5. Press corrector **C** to set Day and activate Hour setting.

6. Press button **D** to adjust hour displayed.
7. Press corrector **C** to set Hour and activate Minutes setting.
8. Press button **D** to adjust minutes displayed.
9. Press corrector **C** to set Minutes and return to Time Mode display.

To select DISPLAY MODE in G3:

Time is the default mode:

1. Press button **D** once to switch from Time mode to Date display.
2. Press button **D** again to view current Seconds.
3. Press button **D** a third time to return to Time mode.



(27) DIGITAL MULTI-FUNCTION MODELS – TYPE A

with 12-digit LED display

Includes Digitale multi-function models



Figure A

LEGEND

UD – Upper LED display
MD – Main LED display
LD – Lower LED display

A, B, C, D – Setting/operating buttons

These sporty digital models with 12-digit LCD displays offer these features and functions:

- Dual Time function (Home and T2, with Summer Time [Daylight Savings] adjustment)
- Choice of 12H or 24H time display format
- Auto Calendar (to year 2069 with Month, Date and Day)
- 5 Alarms with Hourly Chime function
- 3 Countdown Timers
- 1/100 of a second Chronograph function with Lap-time and Split-time counting
- EL (Electro-Luminous) Backlight

OPERATING INSTRUCTIONS



Diagram 1

GENERAL OPERATIONS

- Press button **C** to toggle between Home Time and Time 2.
- Press button **B** to switch between modes in this order:
HOME TIME → ALARM → TIMER → CHRONOGRAPH → HOME TIME
- In any mode, press button **A** to activate the EL Backlight for approximately 3 seconds.

In any Setting Mode:

- Press button **B** to decrease number in active field
- Press button **C** to increase number in active field
- Press button **D** to shift to next field to be set in current mode
- Watch will automatically exit any setting mode after 2 minutes of idle time.

TIME & CALENDAR MODE

In Home Time Mode:

1. Hour and Minute appear in Main display **MD**; Day and Date appear in Upper display **UD**; Seconds appear in Lower display **LD**.
 2. Press button **C** to toggle between Home Time and Time 2.
- NOTE: Available year range is 2000 to 2069; Year will only be displayed in Home Time Setting Mode.
3. Press and hold button **D** for 3 seconds to enter Home Time Setting Mode.

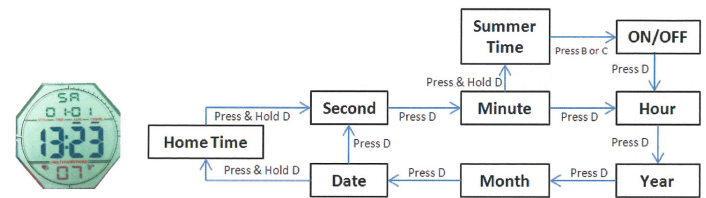

Diagram 2

In Home Time Setting Mode:

1. See Diagram 2 for Time and Calendar setting sequence.

NOTES:

- Press button **B** to decrease or button **C** to increase number in active field.
 - When setting the Hour, a 12H or 24H time format can be selected by adjusting cycle.
 - From Minute Setting display, press and hold button **D** for 3 seconds to enter/exit Summer Time Setting and ON/OFF modes.
 - When Summer Time is ON, displayed time will automatically adjust to 1 hour ahead of the Standard Time at 2:00 AM on the last Sunday in March, and will shift 1 hour back to Standard Time at 2:00 AM on the last Sunday in October.
2. When Time and Calendar settings are complete, press and hold button **D** for 3 seconds to return to Home Time Mode.

In T2 Time Mode:

1. Press and hold button **D** for 3 seconds to enter T2 Time Setting Mode.
2. Press button **B** to decrease or button **C** to increase the Hour.
3. When desired Hour appears in Main display **MD**, press and hold button **D** for 3 seconds to exit T2 Time Setting Mode.

NOTES:

- Only the Hour can be adjusted.
- The adjustment range is +/- 11 hours; the Date and Day will be adjusted automatically.



ALARM MODE

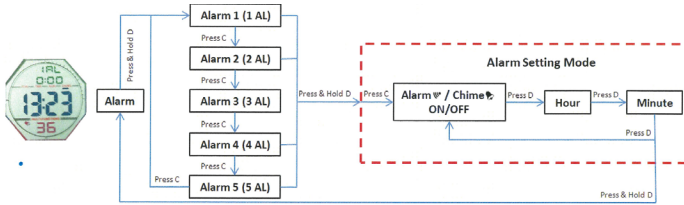

Diagram 3

In Alarm Mode:

1. Home Time Hour and Minute appear in Main display **MD** and Seconds appear in Lower display **LD**, while previous Alarm Setting Times(s) appear in Upper display **UD**. Seconds appear in Lower display **LD**.
2. Press button **C** one or more times to view settings for Alarm 1 through Alarm 5.
3. Press and hold button **D** for 3 seconds to enter Alarm Setting Mode.

In Alarm Setting Mode:

1. See Diagram 3 for Alarm Setting Sequence.

NOTES:

- Press button **B** to decrease or button **C** to increase number in active field.
 - When set Alarm is triggered, watch will beep for 20 seconds
 - When Chime is ON, watch will emit a short beep at the top of each hour.
2. Press and hold button **D** for 3 seconds to exit Alarm Setting Mode and return to Alarm Mode.

TIMER MODE

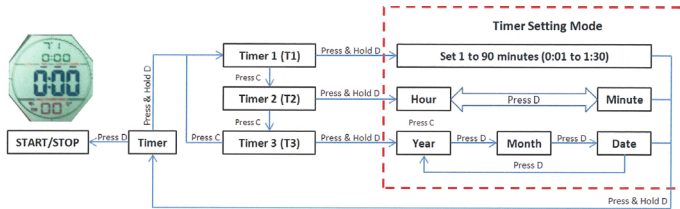

Diagram 4

In Timer Mode:

1. T1, T2 or T3 appears in top row of Upper display **UD**, while zeros appear in bottom row of Upper display **UD**, Main display **MD** and Lower display **LD**.
2. Press button **C** one or more times to view settings for T1 through T3.
3. Press button **D** to start/stop the Timer.

NOTE: Once Timer stops, press **D** to restart the countdown.

4. Press and hold button **D** for 3 seconds to enter Timer Setting Mode.

In Timer Setting Mode:

1. See Diagram 4 for Timer Setting Sequence.

NOTES:

- Timer 1: Maximum countdown time duration is 90 minutes
 - Timer 2: Maximum countdown time duration is 24 hours
- IMPORTANT: Before setting Timer 2, first press button **D** to display Home Time ON/OFF.
- Timer 3: Maximum countdown time duration is 1825 days

- Press button **B** to decrease or button **C** to increase number in active setting field.
 - When set Timer is triggered, watch will beep for 3 seconds
2. Press and hold button **D** for 3 seconds to exit Timer Setting Mode and return to Timer Mode.

CHRONOGRAPH MODE

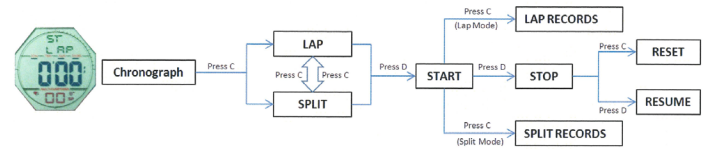

Diagram 5

In Chronograph Mode:

1. Use button **C** to select Lap Time or Split Time Mode.

Lap Time Mode:

Used to time a series of consecutive events such as sequential laps run in a foot race. The timing of each new event in the series begins as soon as the timing of the preceding event is ended.

Split Time Mode:

Used to read intermediate or split times during the course of an ongoing event. The display freezes temporarily so the split time may be read, while the timing of the ongoing event continues in the background.



(28) DIGITAL MULTI-FUNCTION MODELS – TYPE B

with 13-digit LED display

Includes Forza Digital Models



Figure A

LEGEND

UD – Upper LCD display

MD – Main LCD display

A, B, C, D – Setting/operating buttons

These sporty digital models with 13-digit LCD displays offer these features and functions:

- Dual Time - Home Time and Time 2 (T2)
- Choice of 12H or 24H time display format
- Auto Calendar with Year, Month, Date and Day
- Daily Alarm and Hourly Chime
- Timer
- 1/100 of a Second Chronograph with Split Functions
- EL (Electro-Luminous) Backlight

OPERATING INSTRUCTIONS

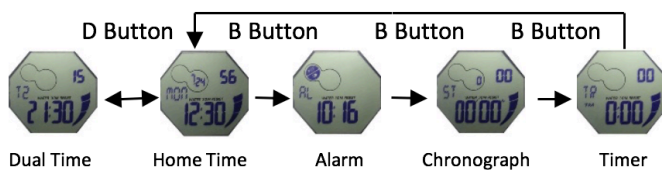

Diagram 1

GENERAL OPERATIONS

- Press button **D** to toggle between Home Time and T2.
- Press button **B** to switch between modes in this order:
HOME TIME → ALARM → CHRONOGRAPH → TIMER → HOME TIME
- In any mode, press button **C** to activate the EL Backlight for approximately 3 seconds.

In any Setting Mode:

- Press button **D** to decrease number in active field (if seconds is selected, the field will be reset to zero).
- Press button **B** to shift to next field.
- The watch will automatically exit any setting mode after 20 seconds of idle time.

TIME & CALENDAR MODE

In Home Time Mode:

1. Hour and Minute appear in Main display **MD**; Day, Date and seconds appear in Upper display **UD**.
2. Press and hold button **A** for 2 seconds to enter Time Setting Mode.

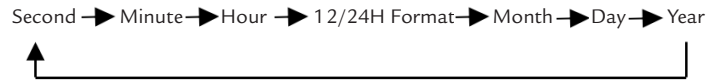

Diagram 2

3. Press **D** button to adjust the flashing field.
 4. Press **B** button to select the next field in the sequence.
 5. Press **A** button to exit the setting mode.
 6. Press button **D** to toggle between Home Time and T2.
- NOTE: If the seconds field is reset at greater than 30s, the time will be rounded up by 1 minute.

In Time 2 (T2) Mode:

1. Press and hold Button **A** for 2 seconds to enter setting mode.
2. Press button **D** to adjust the flashing field.
3. Press button **B** to shift the next setting field.
4. Press **A** button to exit the setting mode.

NOTES: The available year range is 2000 to 2099; Month, Date and Day will only be displayed in Home Time Setting Mode, and not T2 Mode. In T2, only the Hour and Minute fields can be seen or adjusted.

ALARM MODE

In Alarm Mode:

1. Press **D** button to turn on/off Alarm (•••••) and/or Chime (🔔).
 2. Press and hold **A** button for 2 seconds to enter setting mode.
 3. Press **D** button to adjust the flashing field.
 4. Press **B** button to shift the next setting field.
- NOTE: When the set time is reached, alarm will sound for 20 seconds.

CHRONOGRAPH MODE

In Chronograph Mode:

1. Press **D** button to Start/Stop/Restart running time.
2. Press **A** button to split/resume counting.
3. Press **D** button to stop running time and then press **A** button to reset count to zero.

TIMER MODE

In Timer Mode:

1. Press and hold **A** button for 2 seconds to enter setting mode.
 2. Press **D** button to adjust the flashing field.
 3. Press **B** to shift the next setting field.
 4. Press **A** to exit the setting mode.
- NOTE: Counting range is up to 23:59:59 (starting from 00:00:00). When the timer reaches its set time, a chime will sound for 10 seconds.



(29) DIGITAL MULTI-FUNCTION MODELS – TYPE C

with 10-digit LCD display

Includes Digidrive Models



Figure A

LEGEND

A, B, C, D – Setting/operating buttons

These sporty digital models with 10-digit LCD displays offer the following features and functions:

- Choice of 12H or 24H time display format
- Auto Calendar with Month, Date and Day
- Daily Alarm and Hourly Chime
- 1/100 of a Second Chronograph with Split Functions
- EL (Electro-Luminous) Backlight

OPERATING INSTRUCTIONS

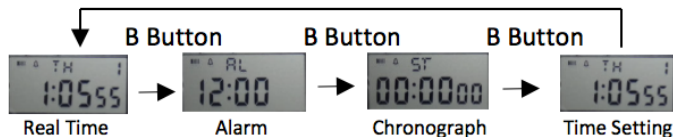

Diagram 1

NOTE: In any mode, press the button A to activate the EL backlight for 3 seconds.

REAL TIME MODE

In Real Time Mode:

1. Press button C to toggle between 12HR and 24HR display format.

ALARM MODE

In Alarm Mode:

1. Press C button to turn on/off Alarm (•••••) or Chime (🔔).
2. To Press A button to select Hour or Minute field.
3. Press C button to adjust the flashing item.
4. Press A button to confirm,
5. press B button to return to Real Time mode.

NOTE: When the set time is reached, the alarm will sound for 20 seconds. Pressing any button stops the alarm chime.

CHRONOGRAPH MODE

In Chronograph Mode:

1. The display range of the Chronograph is 23hour, 59 minutes, 59.99 seconds.
2. Press the C button to Start/Stop running time.
3. When stopped, press A button to reset.
4. When running, press A button to split count.
5. Press C button to exit split count and stop running; press A button to display all counts, press A button again to reset.
6. When running, press B button to return to Real Time Mode. Time keeping will continue running in the background.

Time Setting Mode:

When time setting mode is entered, the seconds field will begin flashing.

1. Press A button to select the next item in the following sequence:

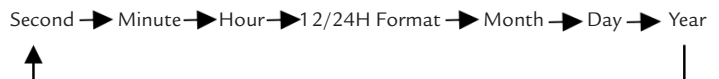

Diagram 2

2. Press C button to adjust the flashing field.

NOTE: In the seconds field, pressing the C button will reset seconds to zero; If the seconds field is reset at greater than 30s, the time will be rounded up by 1 minute.



(30) DIGITAL MULTI-FUNCTION MODELS – TYPE D

with 15-digit display

Includes Downforce digital Models



Figure A

LEGEND

- A – LIGHT/SET
- B – MODE
- C – RESET
- D – START

These digital models with 15 Digit LCD display offer the following features and functions:

- Display hour, minute, second, month, year, day and week
- Graphical animation of day of the week cycled every 10 seconds
- 24 time zone, world time display with independent Daylight-Saving Time (DST) setting
- 3 independent daily alarms and chime
- Choice of 12H or 24H time display format with auto calendar
- 20-lap chronograph with resolution up to 23-hour, 59 minute, 59.99 seconds
- Count down timer with preset value up to 23-hour, 59 minute, 59 seconds
- EL backlight

OPERATING INSTRUCTIONS

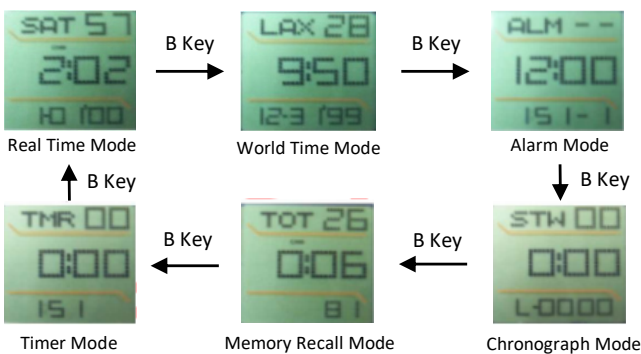

Real Time:

1. Press the **C** key to toggle the DST status of the local city. Time will be updated, and DST indicator will be on/off accordingly.

2. Press **D** key to turn on/off chime indicator “CHM”.
3. Press the **A** key for 2 seconds to enter the time setting mode.
 - a) Entering time setting mode, 12/24 hour will be set and blinking.
 - b) Press **B** key to change to next setting item.
 - c) Press **C** key or **D** key to increase or decrease the setting value. Press and hold the **C** or **D** key for 2 seconds to activate auto-advance.
 - d) Setting sequence will be cycled by 12/24-hour display format, second, minute, hour, year, month, date, local city.
 - e) Exiting the setting mode, the corresponding day of the week will be calculated. The foreign time in the world time display mode will be changed accordingly.

World Time Mode:

1. Press the **C** key to toggle the DST for the foreign city. Foreign display time will be updated, and DST indicator will be on/off accordingly.
2. Press **D** key to change to the next display city. If **D** key is pressed and held for 2 seconds, auto-advance function will be activated.

Daily Alarm:

1. Press the **C** key to toggle on/off the displayed alarm time.
2. Press the **D** key to change to the next alarm time display. There can be up to three different alarms.
3. Press the **A** key for 2 seconds to enter the alarm time setting mode.
 - a) Entering the alarm setting mode, alarm minute will be blinking.
 - b) Press **B** key to change to next setting item. Setting sequence will be cycled by alarm minute and alarm hour.
 - c) Press the **C** key or **D** key to increase or decrease the setting value. If the **C** key or **D** key has been pressed and held for 2 seconds, auto-advance will be activated.

Chronograph:

When time setting mode is entered, the seconds field will begin flashing.

1. Press the **D** key to Start/Stop running
2. Press the **D** key to split the running time if chronograph is running. The corresponding lap time will be saved and will blink for 5 seconds. The running time will be resumed afterwards.
3. Press the **C** key to stop the chronograph and the current lap time will be shown for 5 seconds. The total running time will be shown afterwards.
4. Press the **C** key to reset the chronograph once it is stopped. All memory will be reset.
5. If no key is pressed for 60 seconds and the chronograph is not running, the watch will revert to Real Time Display mode.

NOTE: There can be a total of 20 laps recorded. If the number of laps exceeds 20, the last lap will be overwritten.

Memory Recall Mode:

1. In this mode, total running time will be shown on the display.
2. Press the **C** key/**D** key to view the previous or next record.
3. If there is no key operation for 60 seconds, the watch will revert to Real Time Display mode.



Timer Mode:

1. Press the **D** key to start/stop the timer.
2. Press the **C** key to reload the preset value if timer is not running.
3. If timer is not running, press and hold the **A** key for 2 seconds to enter the Timer Setting Mode.
 - a. Entering the setting mode, timer's second value will be blinking.
 - b. Press the **B** key to cycle the setting sequence between the timers second, minute and hour.
 - c. Press the **C** key or **D** key to increase or decrease the setting value. Press and hold either the **C** or **D** key for 2 seconds to activate the auto-advance function.
 - d. Press the **A** key to exit the setting mode. The setting value will be saved as the preset timer value.
4. If there is no key operation for 60 seconds, the watch will exit Timer Setting Mode and return to Timer Display Mode.
5. Once the timer countdown reaches zero, the timer alarm will sound for 30 seconds. Press any key to stop the timer alarm.



(31) DIGITAL MULTI-FUNCTION MODELS – TYPE E

with 12-digit display

Includes Digitrack digital Models



Figure A

LEGEND

- A - LIGHT
- B - MODE
- C - RESET
- D - START

These digital models with 12 Digit LCD display offer the following features and functions:

- Display hour, minute, second, month, day and week
- Daily alarm and hourly chime with snooze function
- Choice of 12H or 24H time display format
- 1/100 second chronograph with split functions
- EL (Electro-Luminous) backlight

OPERATING INSTRUCTIONS

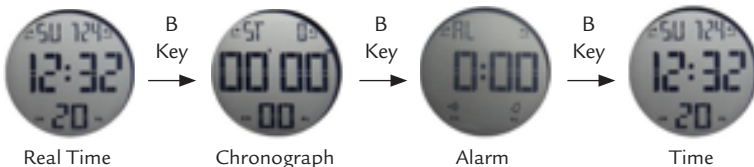

Chronograph:

1. Press the **D** key to Start/Stop running.
2. When stopped, press the **C** key to return to zero.
3. When running, press the **C** key to split count. Indicator “SP” will appear.
4. Press the **D** key to exit split count and stop counting. Press the **C** key again to return to zero.
5. When running, press the **B** key to return to Real Time Mode with chronograph running in the background.

Daily Alarm:

1. Press **D** key to turn on/off Alarm (●) or Chime (🔔).
2. To set alarm, press the **C** key to select “Hour” or “Minute” setting. Press the **D** key to adjust the flashing item. Press the **C** key to confirm and press the **B** key to return to Real Time mode.

3. When an alarm sounds, press the **C** key or **D** key to stop sounding and press the **B** key to turn snooze on or off. When the snooze function is on, it will sound five minutes after and automatically stop after sounding for 20 seconds.

Time Setting:

1. When the seconds are flashing, press the **D** key to return to zero. Press the **C** key to select item in the following sequence:

Hour → Minute → Month → Day → Week → Second

2. When setting the hour, “H” will display for 24-hour format and “A” or “P” for 12-hour format.
3. Press the **D** key while the seconds are between 30 and 59 to reset them to zero and add 1 number to the minutes. In the range of 0 to 29 seconds, the minutes are unchanged.



(32) CHILDREN'S SPECIALTY DIGITAL MODELS

with 4-digit LED display, light and sound features

Includes select Young Collection models



Figure A



Figure B

LEGEND

DD - Digital time display
S1 - Setting button 1
S2 - Setting button 2
LS - Light/sound activation button

These fun digital models featuring 4-digit LCD displays with time, calendar, and simple stopwatch functions also light-up and play race car sounds.

To set CALENDAR and TIME:

A 12:00

1. Begin with TIME showing in digital display **DD**.

B 12
 ● S2 ○ S1

2. Press button **S1** twice to show MONTH.

3. Press button **S2** until desired MONTH appears in digital display **DD**.

C 6
 ● S2 ○ S1

4. Press button **S1** once again to show DATE.

5. Press button **S2** until desired DATE appears in digital display **DD**.

D 9: A
 ● S2 ○ S1

6. Press button **S1** once again to show HOUR with AM/PM indication.

7. Press button **S2** until desired AM or PM HOUR appears in digital display **DD**.

E :10
 ● S2 ○ S1

8. Press button **S1** once again to show MINUTES.

9. Press button **S2** until desired MINUTES appear in digital display **DD**.

10. Press button **S1** once to exit Setting Mode.

11. Press button **S2** once to show set TIME: blinking dots indicate watch is running.

To check DATE:

1. From TIME display mode, press button **S2** once to show DATE.

NOTE: If digital display **DD** flashes from TIME to DATE, press button **S1** five times to return to TIME display mode.

To activate STOPWATCH:

1. From TIME display mode, press button **S2** twice to show STOPWATCH.

2. Press button **S1** once to restart timing from 0:00.

NOTE: STOPWATCH timing runs continuously in the background until restarted.

3. To return to TIME display mode, press button **S2** once.

To activate LIGHT/SOUND features:

1. Press button **LS** once: watch elements will light up and motor raceway sounds will play.



SPECIAL FEATURES

(A) ROTATING REFLECTOR RING

Select Scuderia Ferrari models feature a rotating reflector ring for measuring elapsed time. Located under the crystal and controlled by a screw-down crown at 2 o'clock, the reflector ring can be used to monitor the number of minutes that have elapsed on a timed excursion – for example, since you put money in a parking meter:

1. Unlock the screw-down reflector ring crown by pressing on it gently while turning it counterclockwise approximately six rotations until it pops out.
2. Turn the crown in either direction to align the reflector ring's arrow marker with the current position of the minute hand on the watch dial.
3. Screw the reflector ring crown back down into the case by turning clockwise while gently pressing in on it until you feel resistance. Do not over-tighten.
4. As the minute hand advances around the dial, the number it points to on the reflector ring indicates how many minutes (1 to 59) have passed since you began the timing.
5. When not in use, realign the reflector ring arrow at 12 o'clock, being sure to screw the reflector ring crown back down into the case to assure water resistance.



SPECIAL FEATURES (B) MESH BRACELET SLIDING CLASP

Includes select Donna, Gran Premio and Ultraleggero models

The mesh bracelets found on select models feature a hooking jewelry clasp that allows you to size the bracelet by sliding the pin-bar half of the clasp along the bracelet to achieve a customized fit.

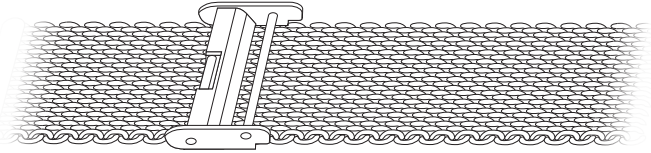

Above: Open mesh bracelet side with pin-bar half of sliding clasp locked in position.

To size the bracelet:

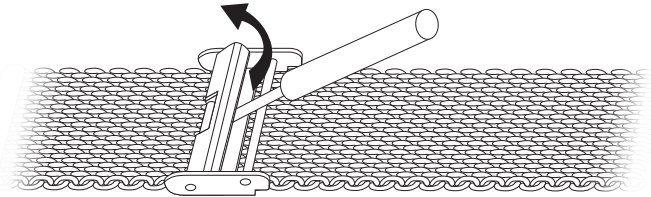

1. Use tool such as a small flat-head screwdriver to pop open metal plate on pin-bar half of clasp, releasing the clasp position locking mechanism.

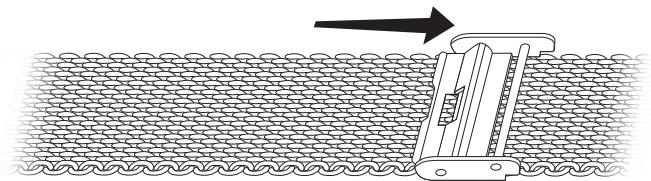

2. Slide pin-bar half of clasp along the mesh bracelet in either direction to desired position.

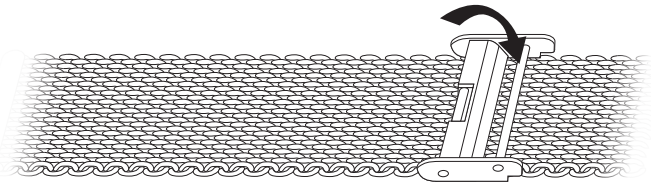

3. Close metal plate, locking the pin-bar half of the clasp in new position on the bracelet.



SPECIAL FEATURES

(C) INTERCHANGEABLE BRACELET/STRAP MODELS

Tension-pin style

Removing Strap (a)

Replacing Strap (b)

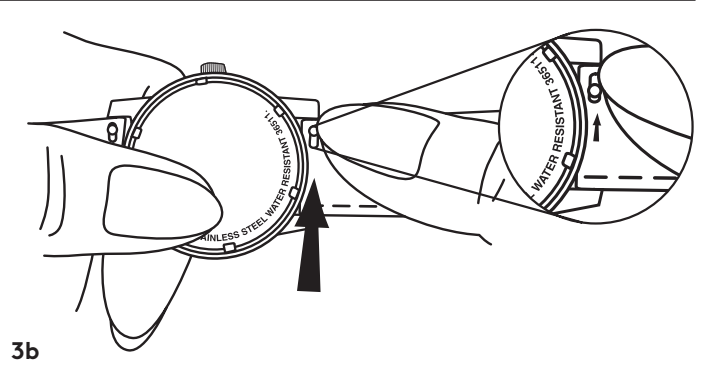
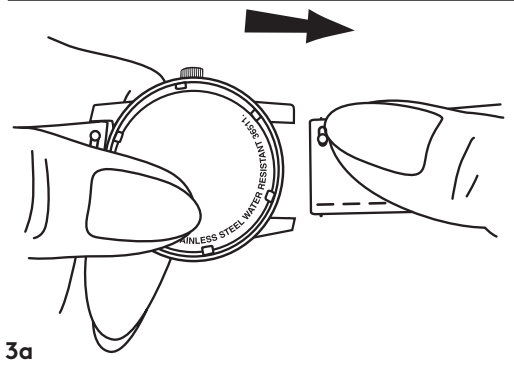
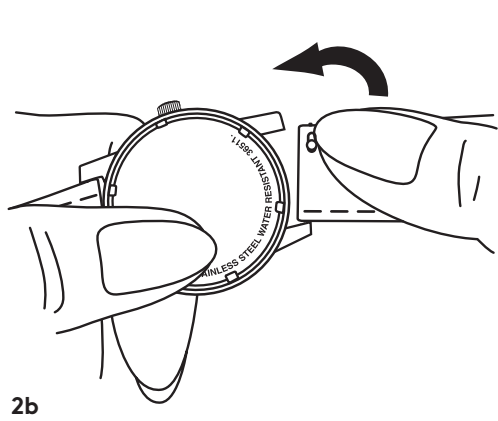
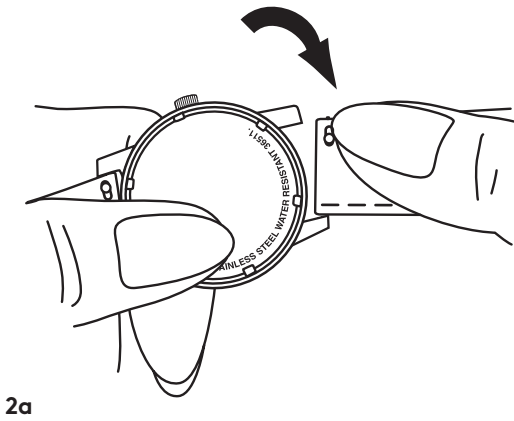
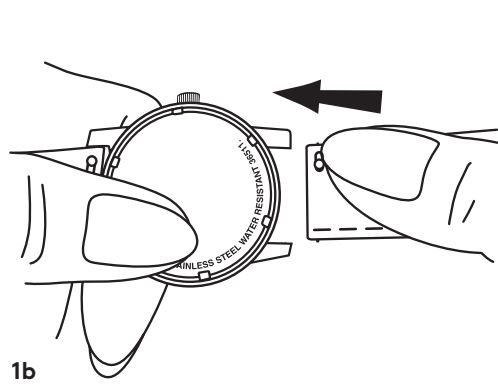
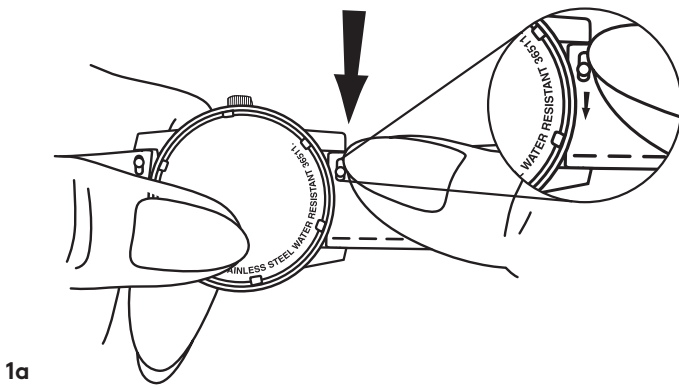

CARE AND MAINTENANCE

Your Scuderia Ferrari watch has been developed with meticulous attention to quality, function and detail. Please read the following information and instructions carefully to learn about the features, proper care and operation of your new watch.

For additional information on service and repairs, please see the Warranty section.

Shock

All of our watches have shock-resistant movements and are tested to meet international standards for shock resistance.

Magnetism

The exposure of a timepiece to a strong magnetic field will affect its time-keeping, and may cause it to stop. A quartz watch should resume working with its original accuracy when removed from the magnetic field; an automatic or hand-wound mechanical timepiece, however, may require demagnetization before it will operate again.

Water Resistance

All Scuderia Ferrari watches are tested to meet international standards for water resistance.

Most styles are water resistant to 3 bar (3ATM/30 meters/99 feet); certain models are water resistant to even greater pressures, as marked on the dial or case-back. These indications do not correspond to a diving depth but rather refer to the pressure at which the tests required to meet the international water resistance standard were conducted.

CAUTION: If the water resistance limit is not marked on your watch, do not subject it to a pressure/depth greater than 3 bar (3 ATM/30 meters/99 feet), or your watch could be damaged and your warranty will be voided.

IMPORTANT: Do not operate the watch crown, push-buttons on a chronograph model, or any other pushers/ buttons when the timepiece is wet or under water.

NOTE: Scuderia Ferrari Orologi (SFO) will not be responsible for any damage caused by or related to leakage originating from improper handling or damage to the case, crown, gaskets or crystal.

To maintain water resistance, yearly maintenance is required. The gaskets and crown which seal the case are subject to wear and deterioration under normal use. These parts should be inspected and replaced as needed each time the watch is opened for service, including battery changes.

Your Authorized SFO Service Center will automatically retest your watch for water resistance as a routine step in all service orders.

Battery Information

Your quartz analog watch or chronograph has a battery specially designed for watches. It will last approximately 18-36 months under normal use.

NOTE: Frequent use of special functions, like the stopwatch timer on chronograph models, may shorten battery life.

End-of-life feature: The seconds hand on many models will start to move haltingly in 4-second increments when the battery is almost exhausted, signaling the need to have it replaced.

Battery replacement: Take or send your watch to an Authorized Service Center to have battery changed – your old battery will be disposed of/ recycled properly. Do not attempt to change the battery yourself.

Collection and treatment of end-of-life quartz watches*

 This symbol indicates that this product should not be disposed of with household waste. It has to be returned to a local authorized collection system. By following this procedure, you will contribute to the protection of the environment and human health. The recycling of the materials will help to conserve natural resources.

*Valid in the EU member states and in any countries with corresponding legislation.



WARRANTY

Not only is each Scuderia Ferrari watch beautiful in design, it is crafted with quality materials and components to offer precise, reliable performance. We proudly stand behind every Scuderia Ferrari watch we sell.

Limited Warranty

Scuderia Ferrari Orologi (SFO) warrants to the original consumer that, for a period of two (2) years from the date of purchase, his/her watch will be free from defects in materials and workmanship that prevent the watch from functioning properly under normal use.

Our responsibility for defects covered by this warranty is limited to repairing or (at the sole discretion of SFO) replacing the defective watch, free of charge.

This limited warranty does not cover analog batteries, straps, bracelets, crystals, gold- or ionic-plating or PVD finishing, cosmetic issues such as scratches or normal wear and tear, or any damage arising from accidents or misuse, or from any alteration, service or repair performed by any party other than an SFO Authorized Service Center.

This warranty is void if the timepiece was not purchased from an Authorized SFO Dealer, as evidenced by valid proof of purchase – a dated sales or gift receipt showing the name of the retailer and an identifying style number for the Scuderia Ferrari watch.

Any other warranty provided by the retailer is entirely their responsibility. No person or company is authorized to change the terms of this warranty. This warranty gives the consumer specific legal rights. He/she may also have other statutory rights which may vary from state to state and country to country. However, to the extent not prohibited by law, this limited warranty is exclusive and in lieu of all other warranties, oral, written, statutory, express or implied (including without limitation the warranties of merchantability and fitness for a particular purpose), all of which are expressly disclaimed.



OBTAINING SERVICE

Under Warranty

Should warranty service be required, pack your watch properly (see below) and send it along with (1) your dated sales or gift receipt showing name of retailer and an identifying watch style number and (2) a completed copy of the Scuderia Ferrari Orologi Service Request Form from this file to the nearest Scuderia Ferrari Orologi Service Center. For a list of centers, return to the Scuderia Ferrari home page on this website and click on the Find a Watch Repair location link.

Out of Warranty

Authorized Scuderia Ferrari Orologi Service Centers can also perform repairs not covered by the Scuderia Ferrari Orologi warranty as well as service after the expiration of the warranty period.

Should your watch require parts or service not covered under the terms of your warranty, a written estimate will be sent for your approval and payment before the work is undertaken. A Service Request Form is provided at the end of this file.

Packing Your Watch

Pack your watch securely in padded wrapping materials for protection against shock. Be sure to include a completed copy of the Scuderia Ferrari Orologi Service Request Form.

Insuring Your Watch

We recommend that you use registered mail and insure your watch for its full replacement value.

Additional Instructions

Charges will be made for all repairs unless your dated sales or gift receipt showing name of retailer and an identifying watch style number is returned with the product and repairs are covered under terms of warranty.



SERVICE REQUEST FORM

Your Name _____

Address _____

City _____

State/Province _____

Country _____

ZIP/Postal Code _____

E-mail _____

Phone (_____) _____

Watch Model # _____

What needs service, replacement or repair: _____

